





Assembly Instructions

Please keep for future reference

ASTON Wall Mounted Foldable Kitchen Table

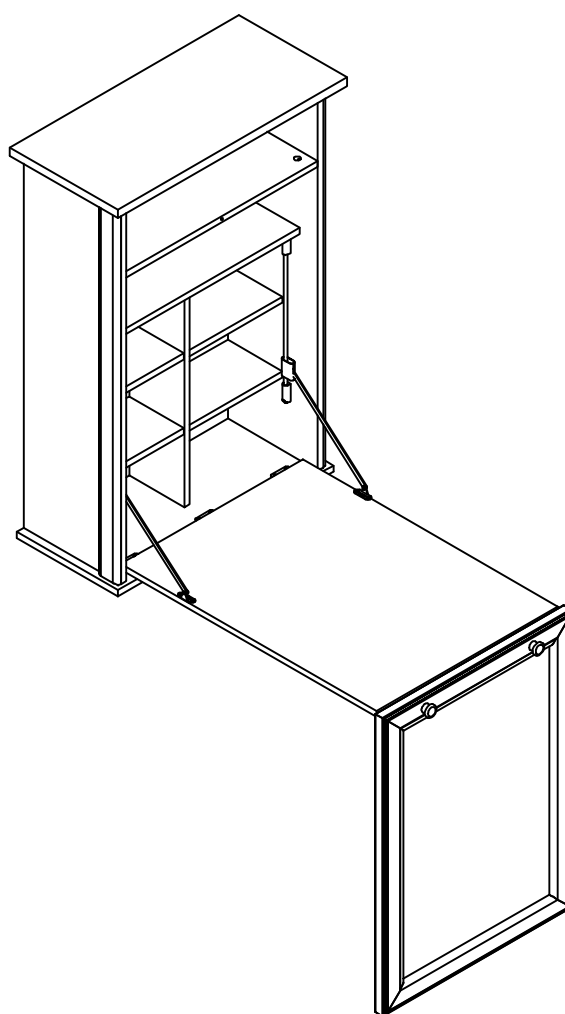
CAT NO: BC769



Dimensions	No. people	Assembly Time
Width: 680 mm Depth: 320 mm Height: 1014 mm		2 hr

Important - Please read these instructions fully before starting assembly

If you need help damaged or missing parts, call the **JDW Customer Helpline: 0871 231 2000**

FSC® certified furniture

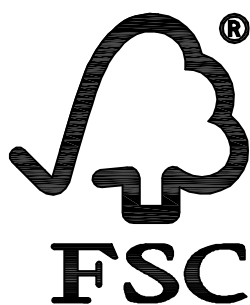

As a raw material for making furniture, wood has no equal - from its vibrancy through its aesthetics to its many design possibilities.

But the wood from which this furniture is made has even more to offer:

The FSC label proves that the wood used comes from forests managed to strict ecological, social and economic standards with lasting effect. This means, for example, that forest biodiversity is maintained and overexploitation does not take place.

Environmental organisations, forest owners, representatives of the wood industry and unions, amongst others, have come together in the FSC to support the responsible management of forests around the world.

Independent certification companies certify the origin of the wood and only award the quality mark if the principles and criteria of the FSC have been met. The tracking of the timber through processing chain from the forest to the market ensures that the seal of the FSC certificate can be trusted.

This represents a step towards the future, because sustainable management of our forests secures their long-term preservation, biodiversity and thus the quality of life for the generations of today and of tomorrow.

Your product development team

Dear customer,

Thank you for your order!

No matter if you bought a piece of furniture made from natural wood, a high-gloss front or a plastic front - every piece of furniture has unique characteristics.

This page provides some care tips for your piece of furniture so that you can enjoy it for a long time.

The following applies in general:

- Don't place any hot objects on the furniture.
- Don't place candles directly on the furniture.
- Immediately wipe off any spilled liquids.
- Regularly check if the screws and fittings are tight.
- Keep these notes in a safe place.

Care notes for furniture made of panel materials

We recommend using a soft, lint-free cloth or a shammy for conditioning your piece of furniture made of panel materials. Wipe off the surfaces with a slightly damp cloth or shammy.

The following applies in general:

Please don't use the following detergents or cleaning agents at all:

- **microfibre cloths or dirt erasers.** They often contain fine abrasive particles which can cause scratches on the surfaces;
- **aggressive chemical substances as well as abrasive cleaning agents or solvents.** They may damage the surfaces too;
- **scouring powder, steel wool or scouring pads.** They destroy the surface so badly that reconditioning is impossible;
- **vacuum cleaners.** The nozzles and brushes can cause scratches on the surfaces;
- **steam cleaners.** The surfaces may be damaged or separated from the ground due to the high pressure and heat of the water vapour.

Your product development team

PART LIST

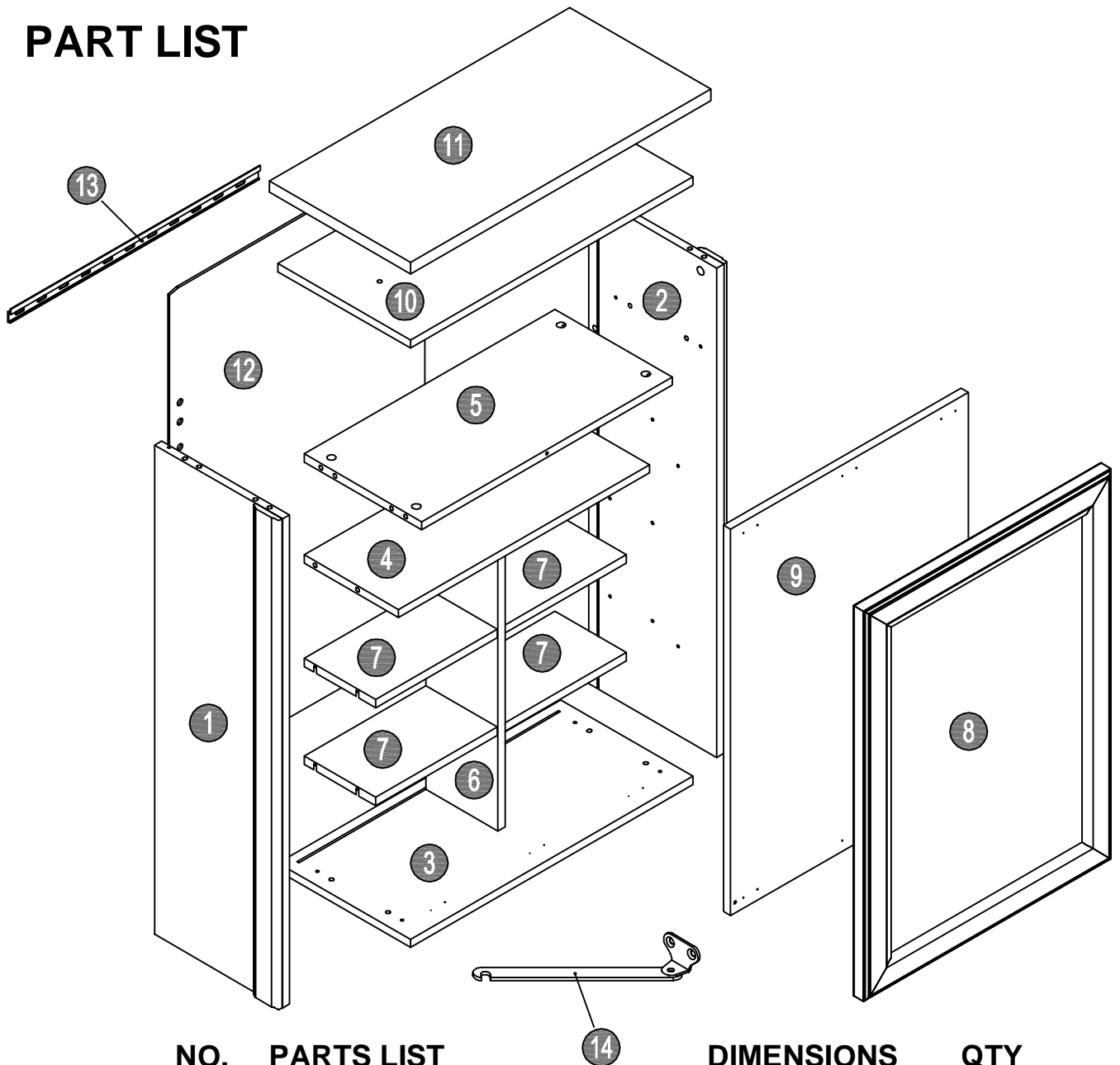

NO.	PARTS LIST	DIMENSIONS	QTY
(1)	LEFT SIDE PANEL	960x289x26	1
(2)	RIGHT SIDE PANEL	960x289x26	1
(3)	BOTTOM PANEL	640x300x16	1
(4)	DIVIDER PANEL	568x214x16	1
(5)	DIVIDER PANEL	568x266x16	1
(6)	DIVIDER PANEL	582x163x16	1
(7)	SHELF	276x162x16	4
(8)	FRONT PANEL	766x560x28	1
(9)	TABLETOP	758x538x16	1
(10)	TOP PANEL	640x300x16	1
(11)	TOP PANEL	680x320x22	1
(12)	BACK PANEL	970x578x3	1
(13)	RAIL	L=565	1
(14)	FLAP STAY	L=115	1

HARDWARE LIST

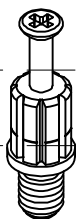

16x

A

CAM BOLT



16x

15x12mm

B

CAM LOCK

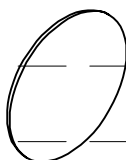

24x

D20mm

C

CAM LOCK COVER

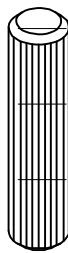

8x

8x35mm

D

DOWEL

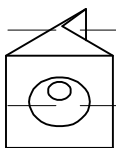

8x

E

HOLDER

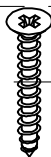

14x

3x20mm

F

SCREW

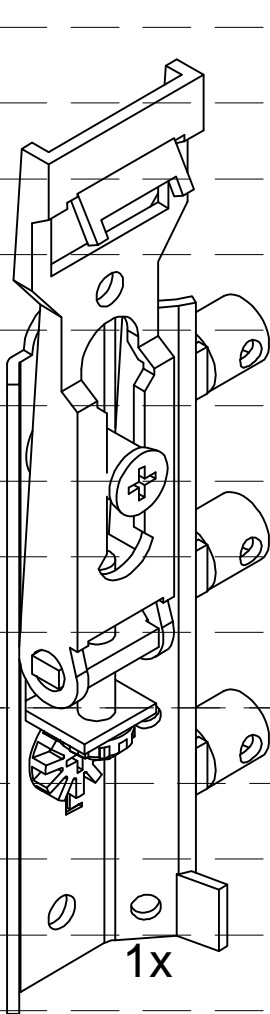

1x

G

SUSPENSION BRACKET

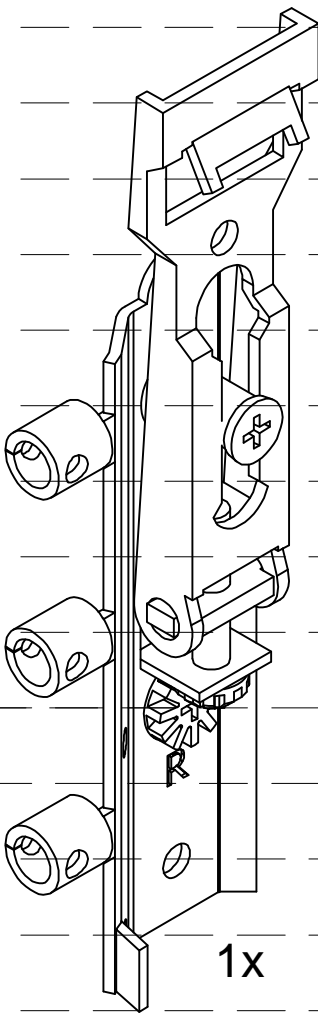

1x

H

SUSPENSION BRACKET



HARDWARE LIST

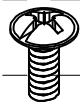

2x
M4x10mm
I
BOLT

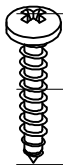

4x
4x20mm
J
SCREW

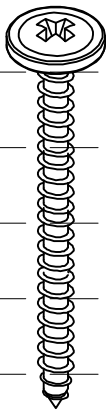

4x
5x45mm
K
SCREW

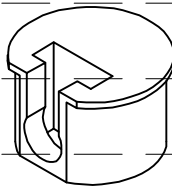

16x
L
CATCH

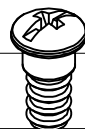

16x
M
SCREW-IN DOWEL

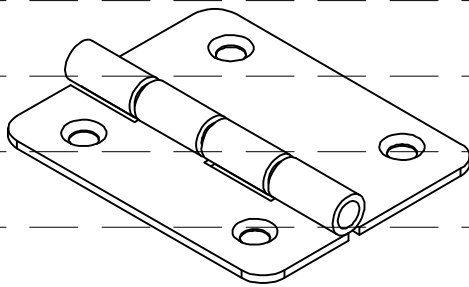

6x
N
HINGE

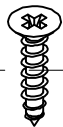

31x
3.5x16mm
O
SCREW

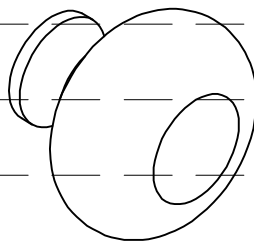

2x
P
HANDLE

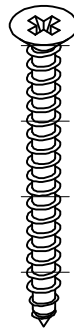

2x
4x40mm
Q
SCREW



2x
R
BUMPER



2x
S
BUMPER

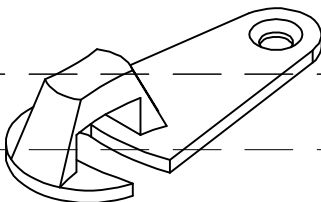

1x
T
HOOK



1x
U
WASHER

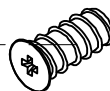

1x
5x13.5mm
V
SCREW

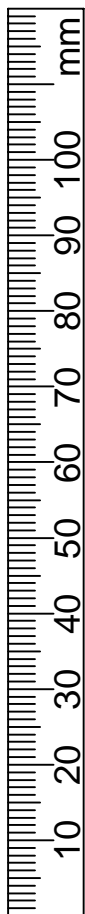

HARDWARE LIST

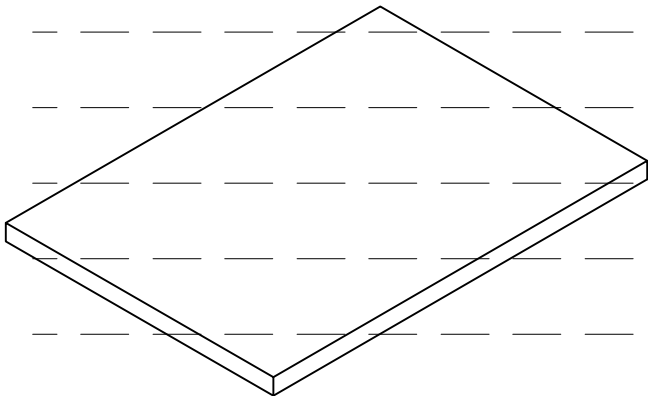

1x
70x50mm
W
FELT PAD

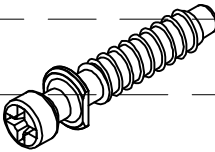

1x
X
SCREW

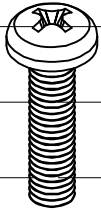

2x
M6x25mm
Y
BOLT

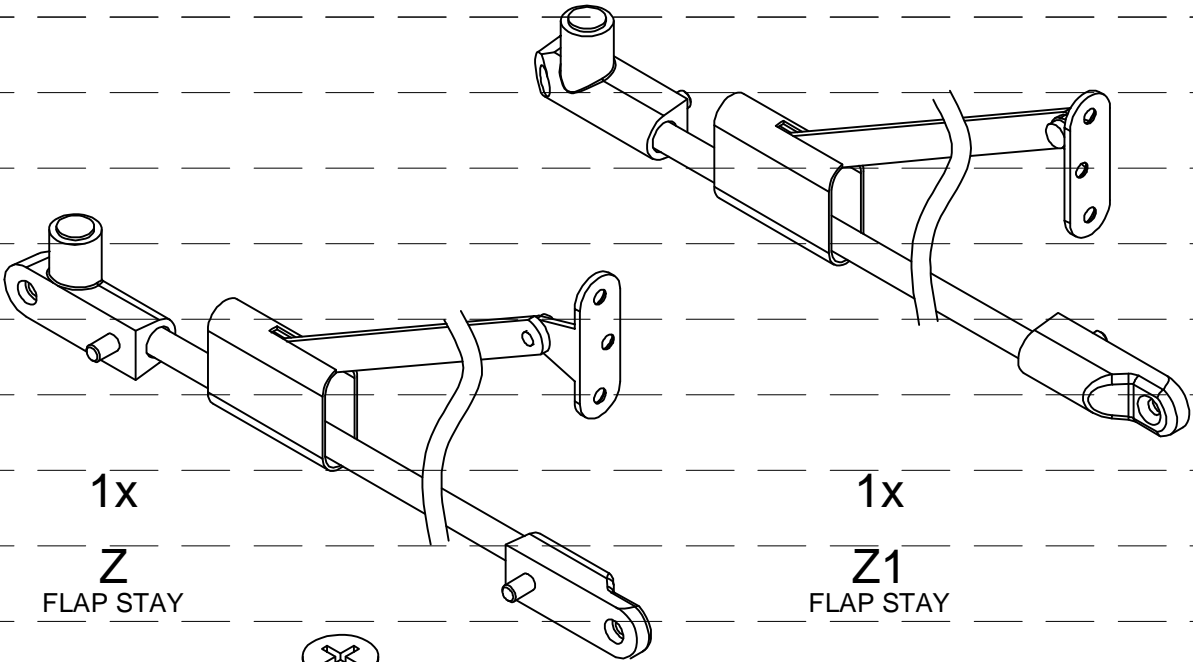

1x
Z
FLAP STAY

1x
Z1
FLAP STAY

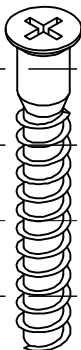

6x
7x50mm
AA
CONFIRMAT



TOP TIPS BEFORE YOU START!

1. Please check that all parts are present before you start the assembly of your furniture, as once assembled, the furniture is exempt from our home approval policy.
2. For ease and speed of assembly, we recommend that before you commence each step of the assembly, that you identify all the parts required for that step.
3. For larger items, please ensure that you have sufficient space and people (as indicated on page 1) to assemble your product safely.
4. We recommend that, where possible, all items are assembled near to the area in which they will be placed in use, to avoid moving the product unnecessarily once assembled.
5. For the protection of your furniture, particularly items of high gloss finish, we recommend that the product is placed on a protected surface during assembly to prevent any damage.
6. During assembly please take care not to over-tighten any fittings, as this may damage the product.

Care and Maintenance of your Furniture

Please periodically check all fittings and re-tighten as necessary.

Please do not sit or stand on this item.

Never allow any kind of liquid to remain on your furniture. Absorption can cause wood to warp or finishes to de-laminate.

Please do not drag and pull your furniture.

STEP 1

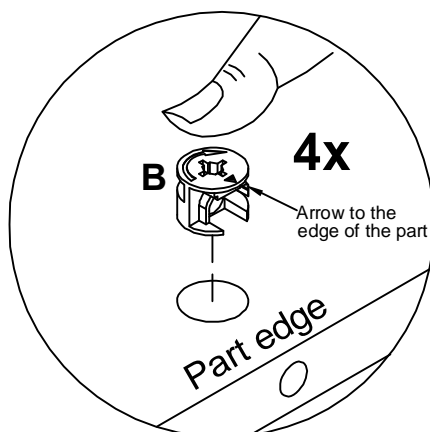
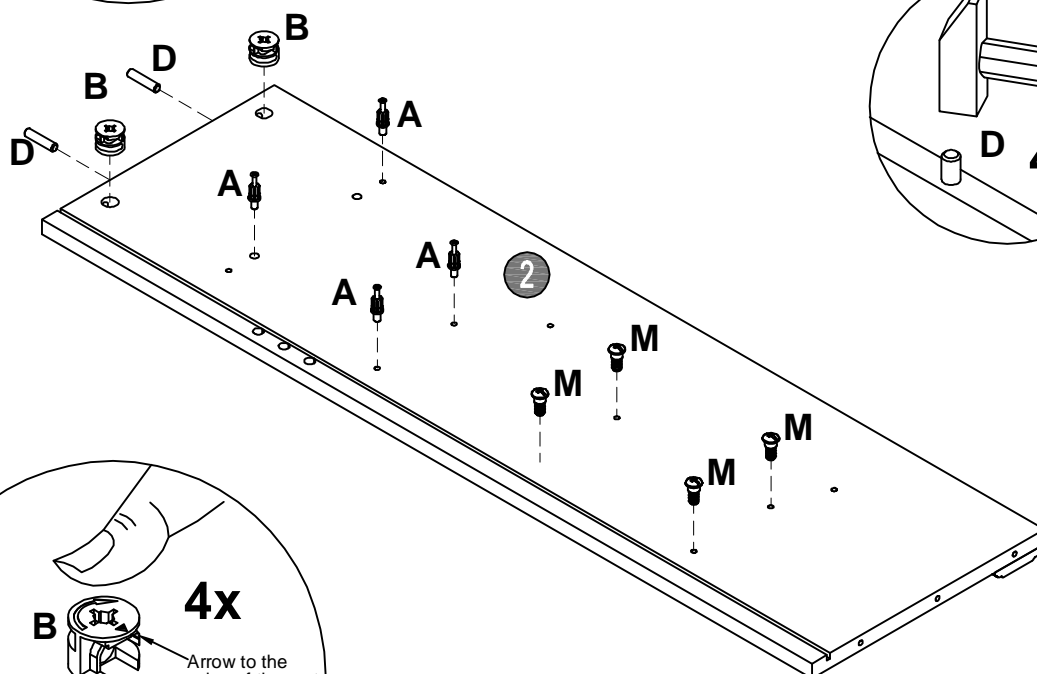
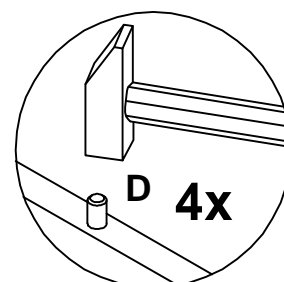
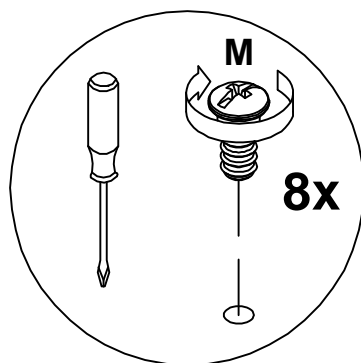
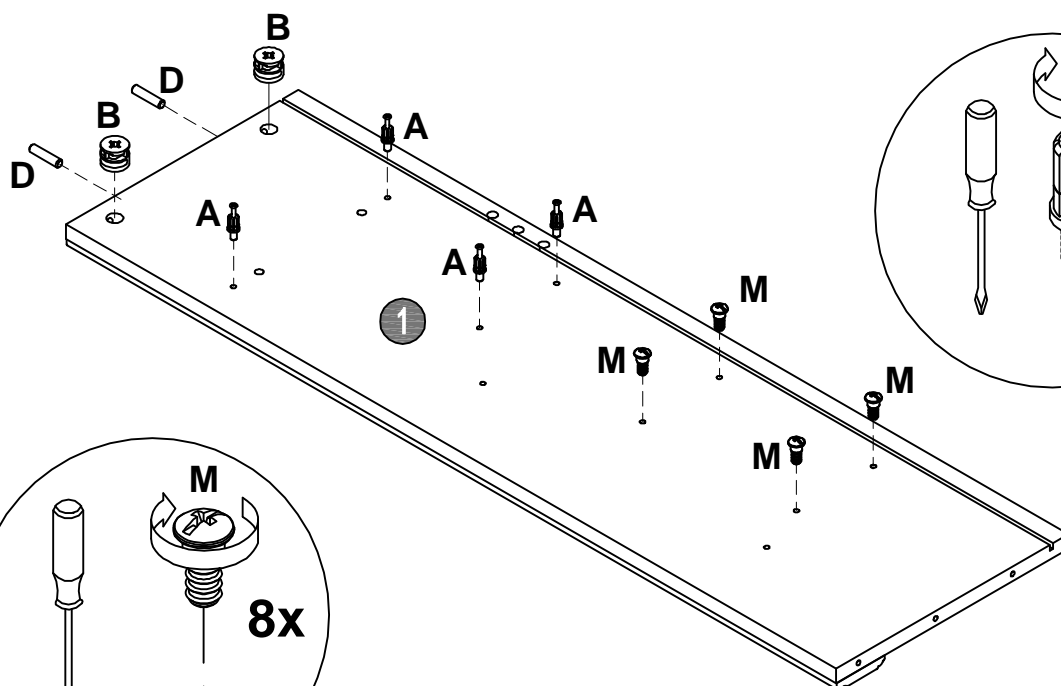

STEP 2

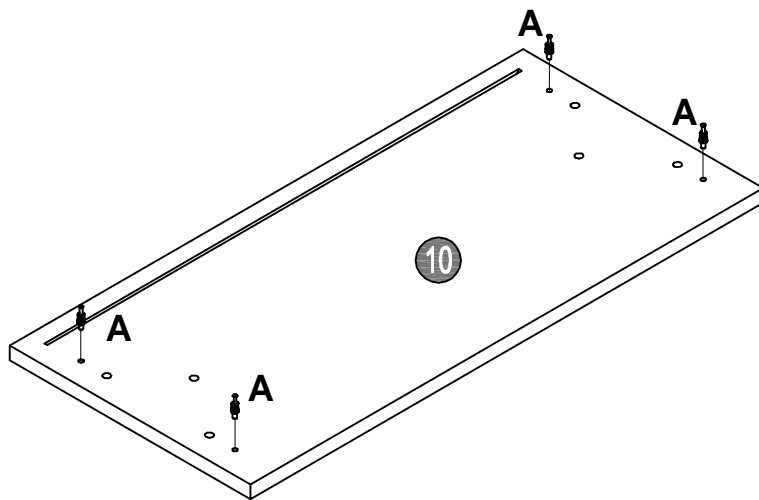

4x
A
CAM BOLT

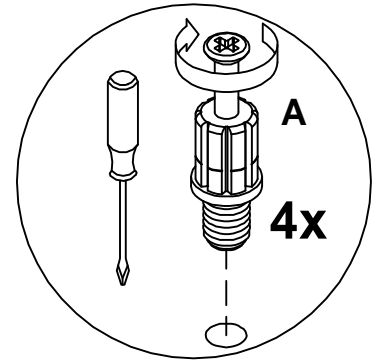

STEP 3

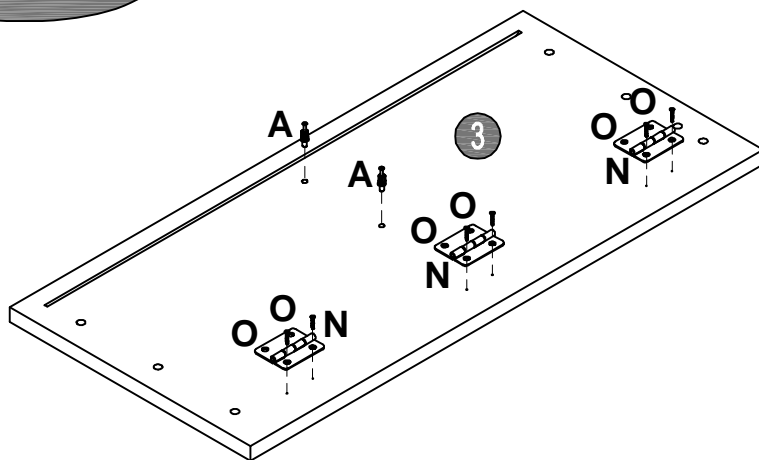

2x
A
CAM BOLT

3x
N
HINGE

6x
3.5x16mm
O
SCREW

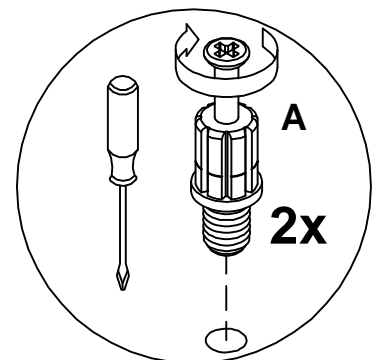
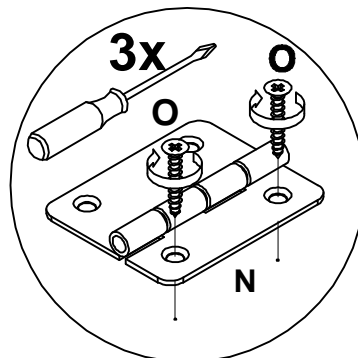

STEP 4

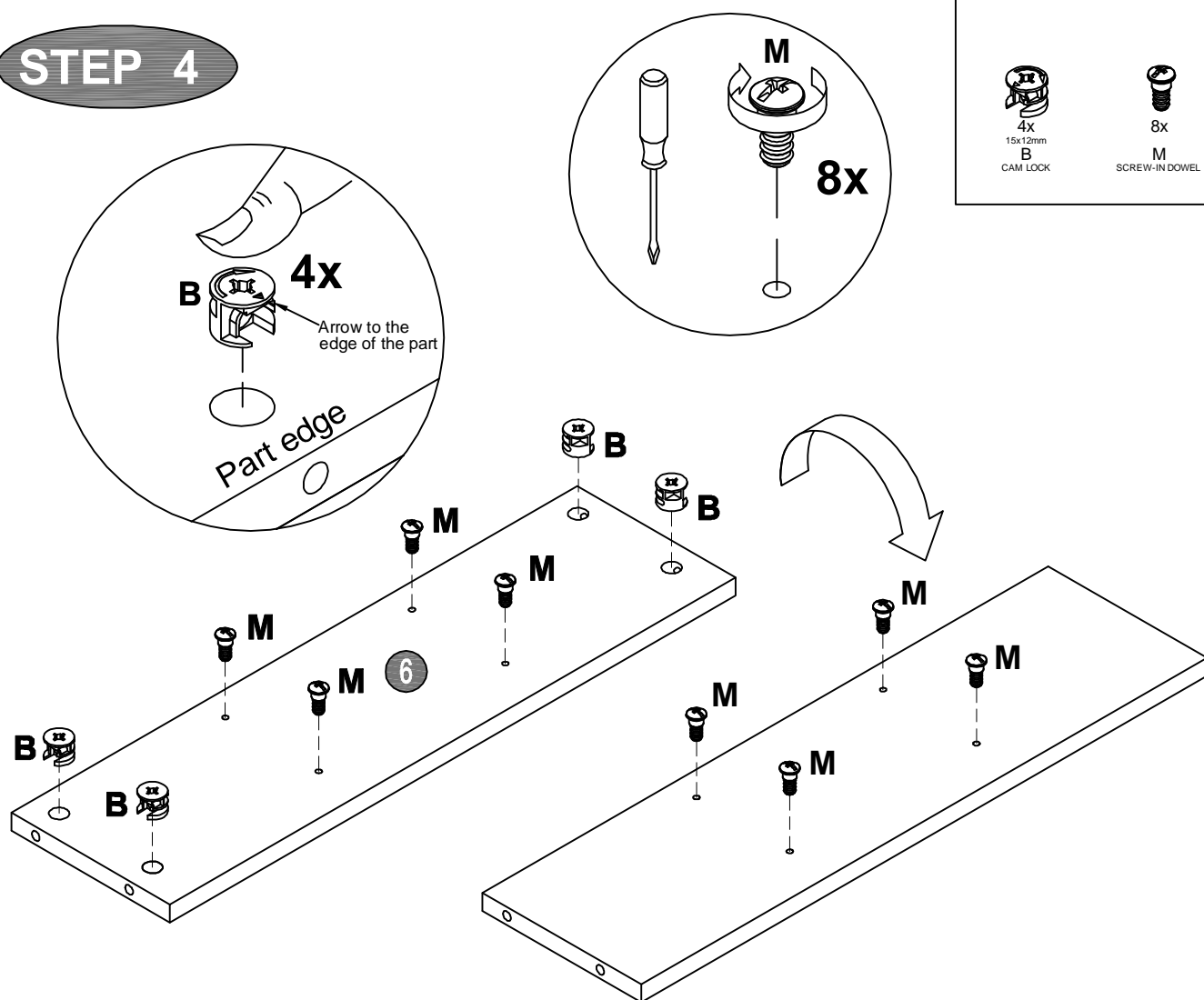

STEP 5

x 4

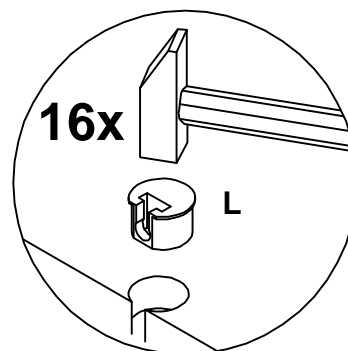
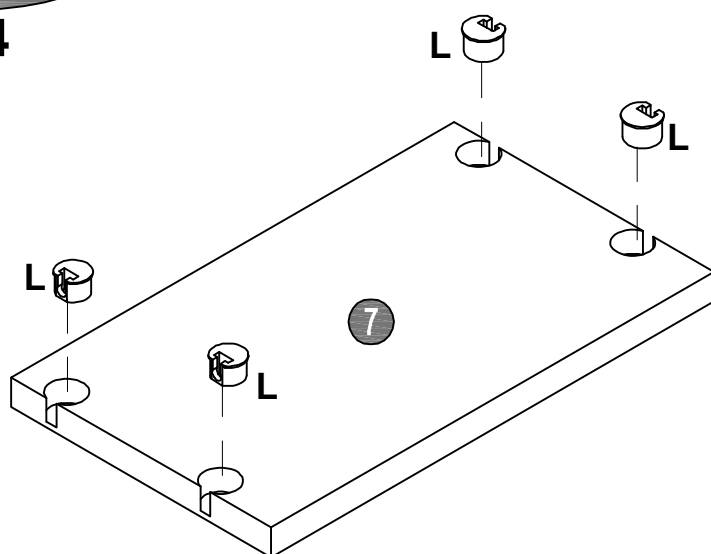

STEP 6

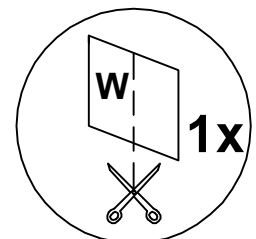
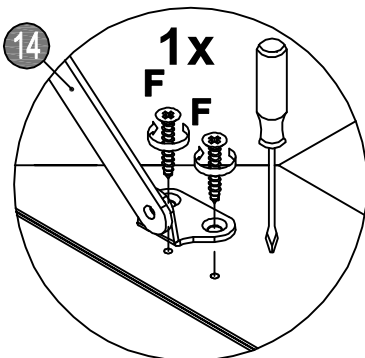
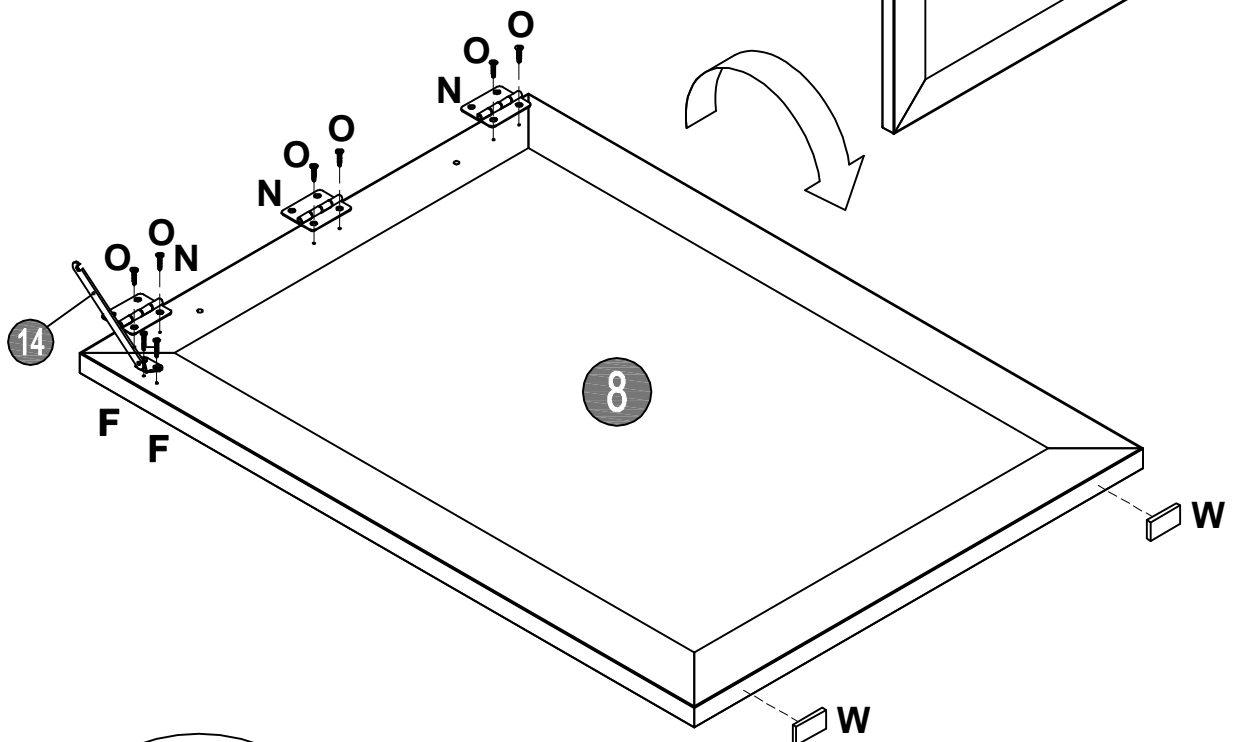
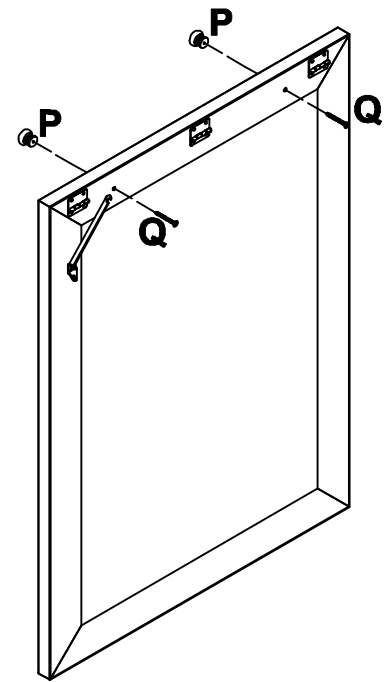
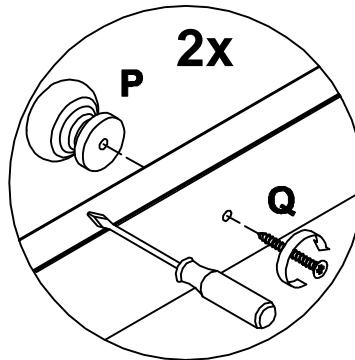
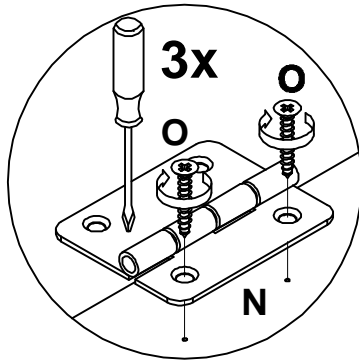
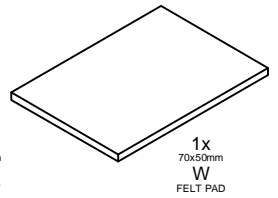
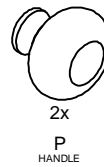
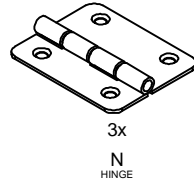

STEP 7

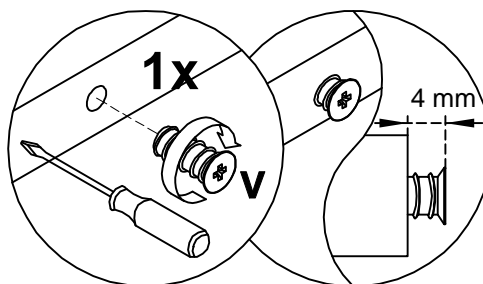
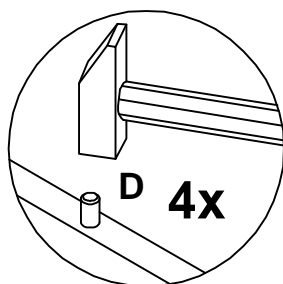
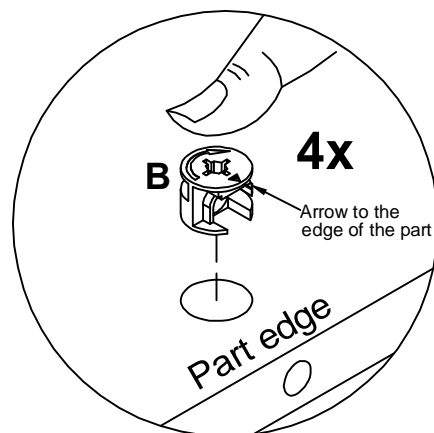
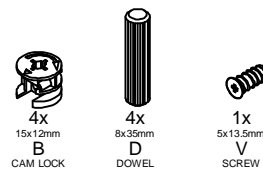
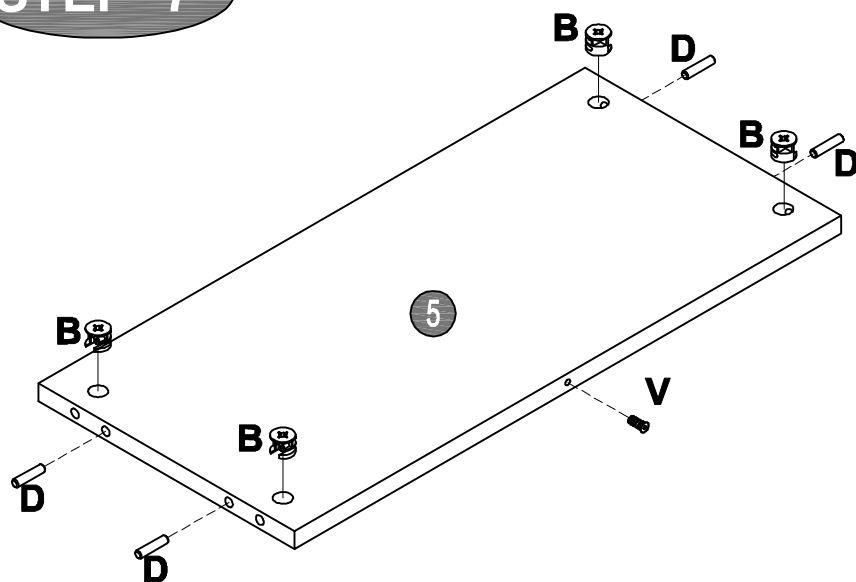

STEP 8

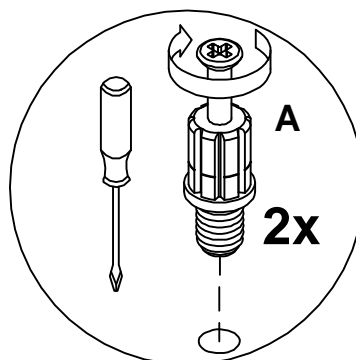
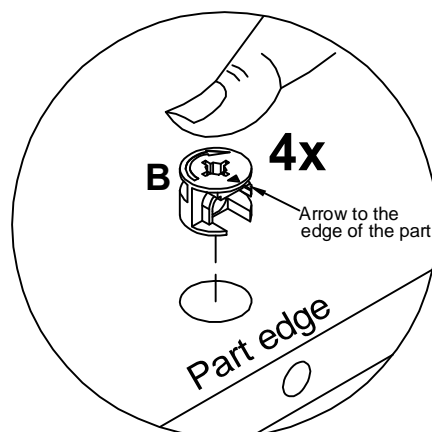
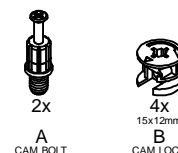
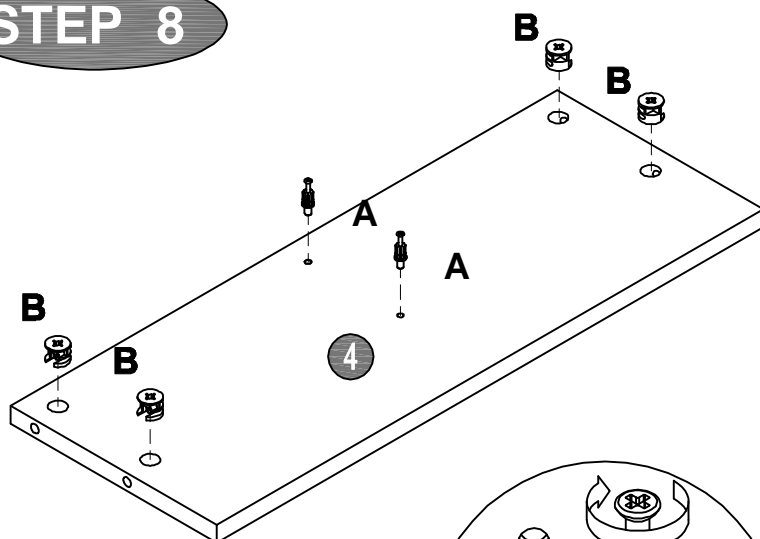

STEP 9

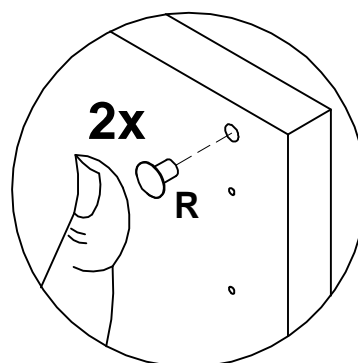
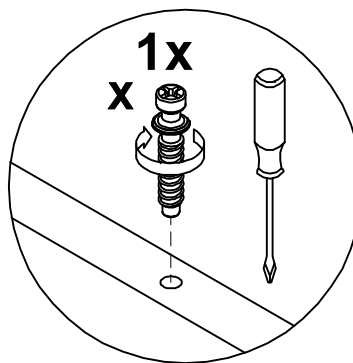
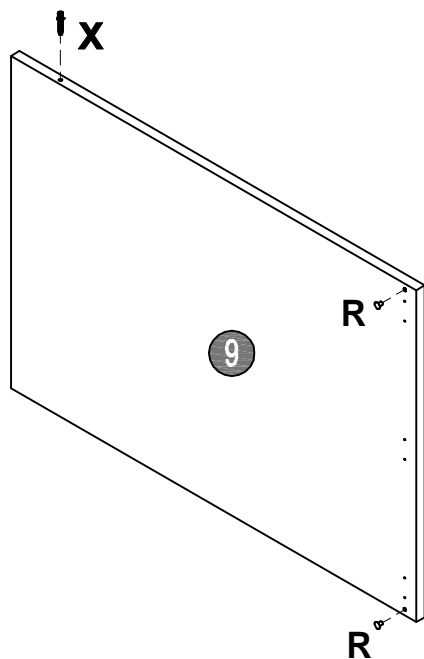

2x
R
BUMPER

1x
X
SCREW

STEP 10

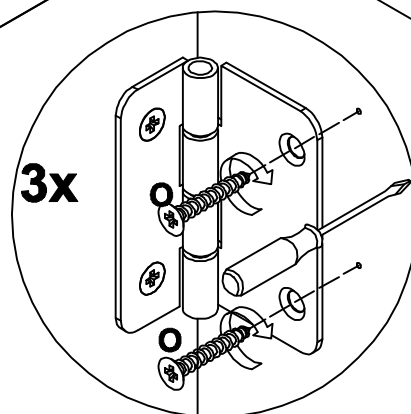
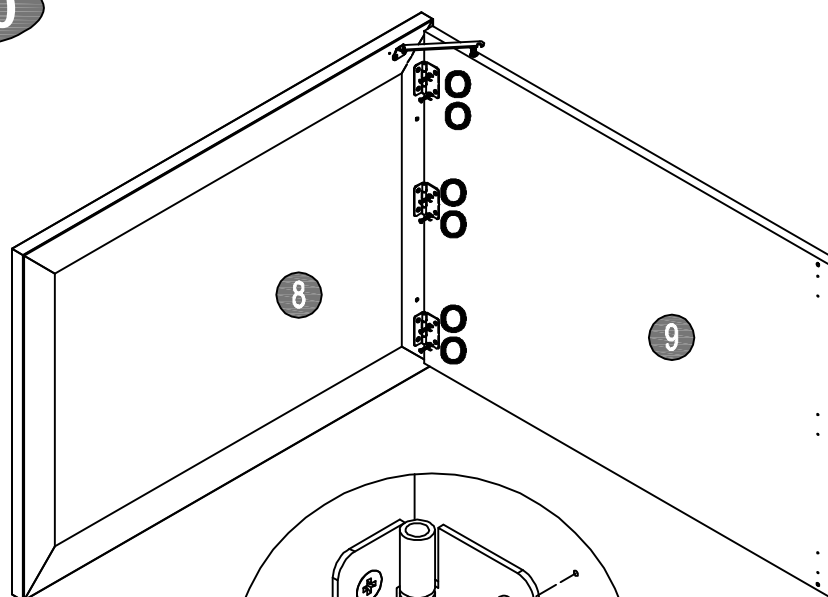

6x
3.5x16mm
O
SCREW

STEP 11

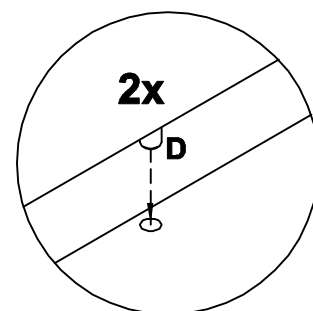
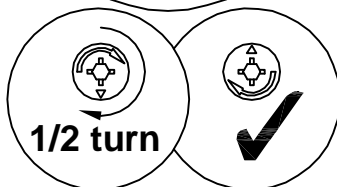
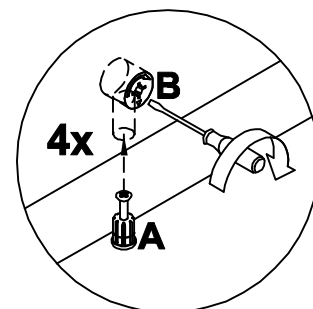
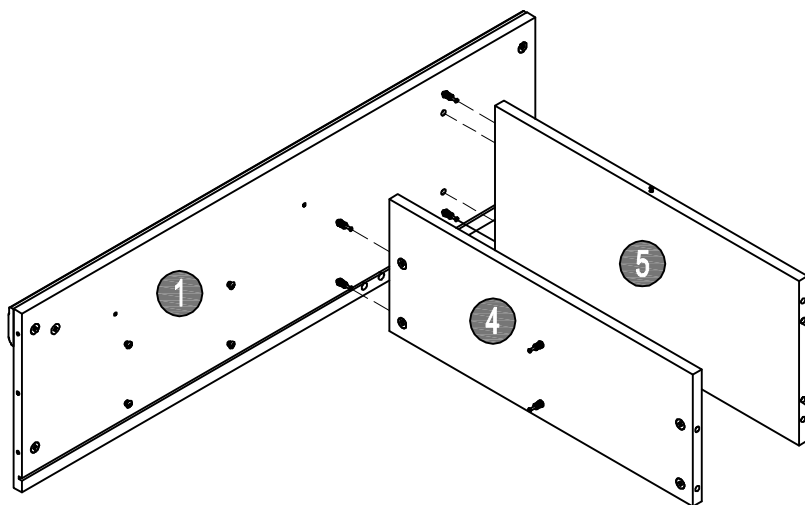

STEP 12

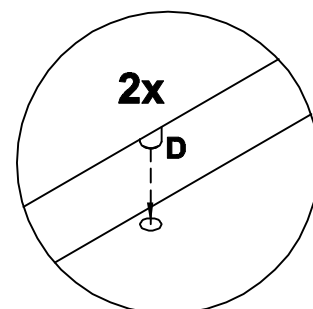
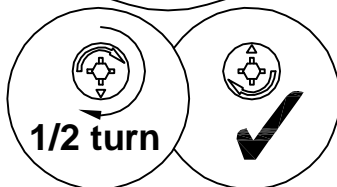
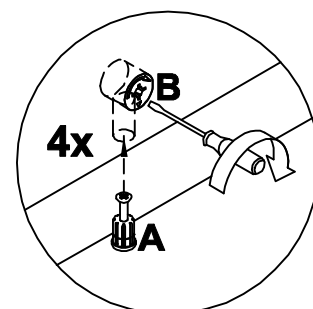
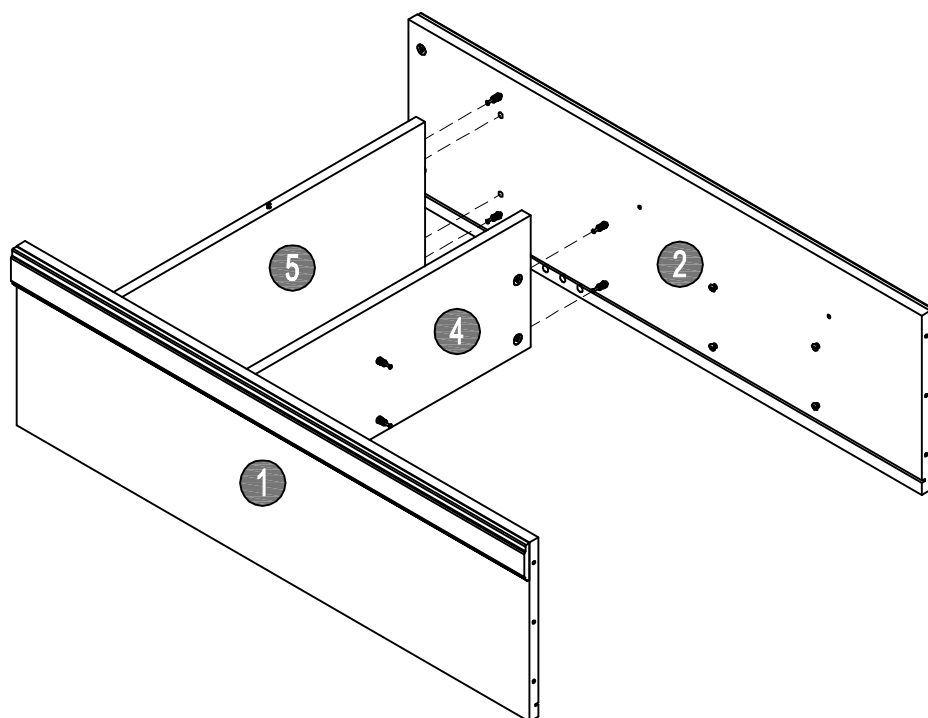

STEP 13

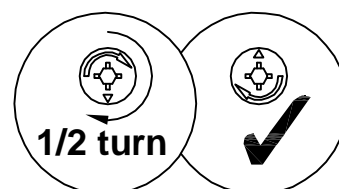
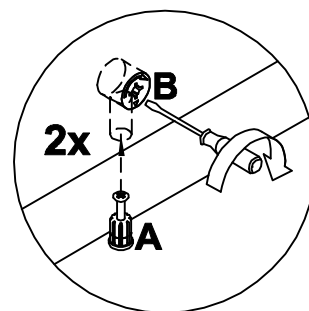
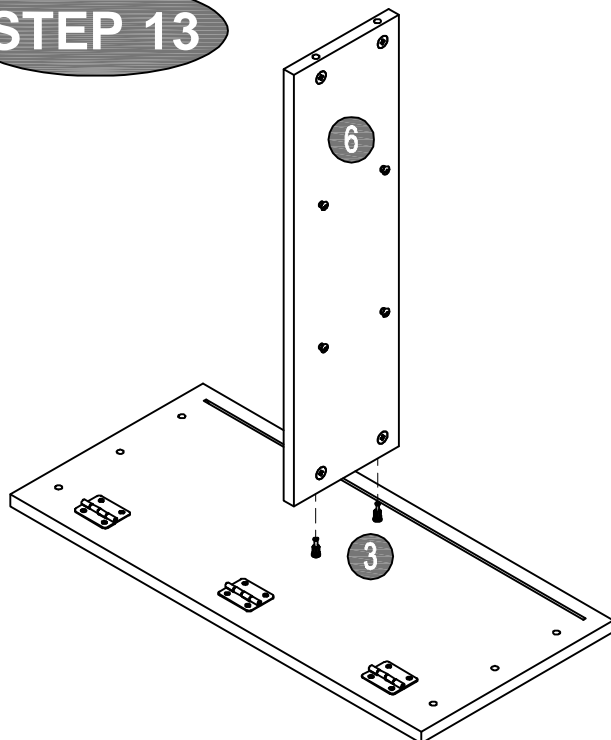

STEP 14

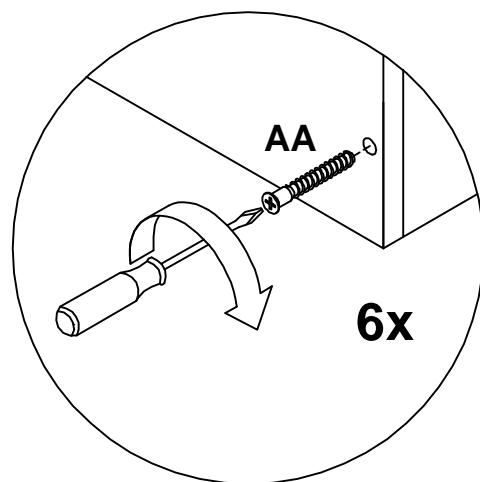
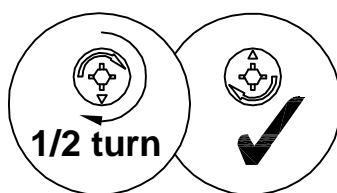
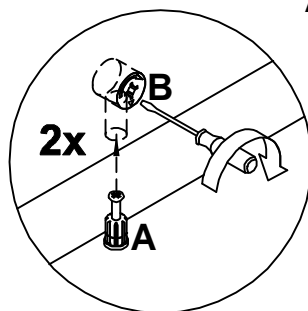
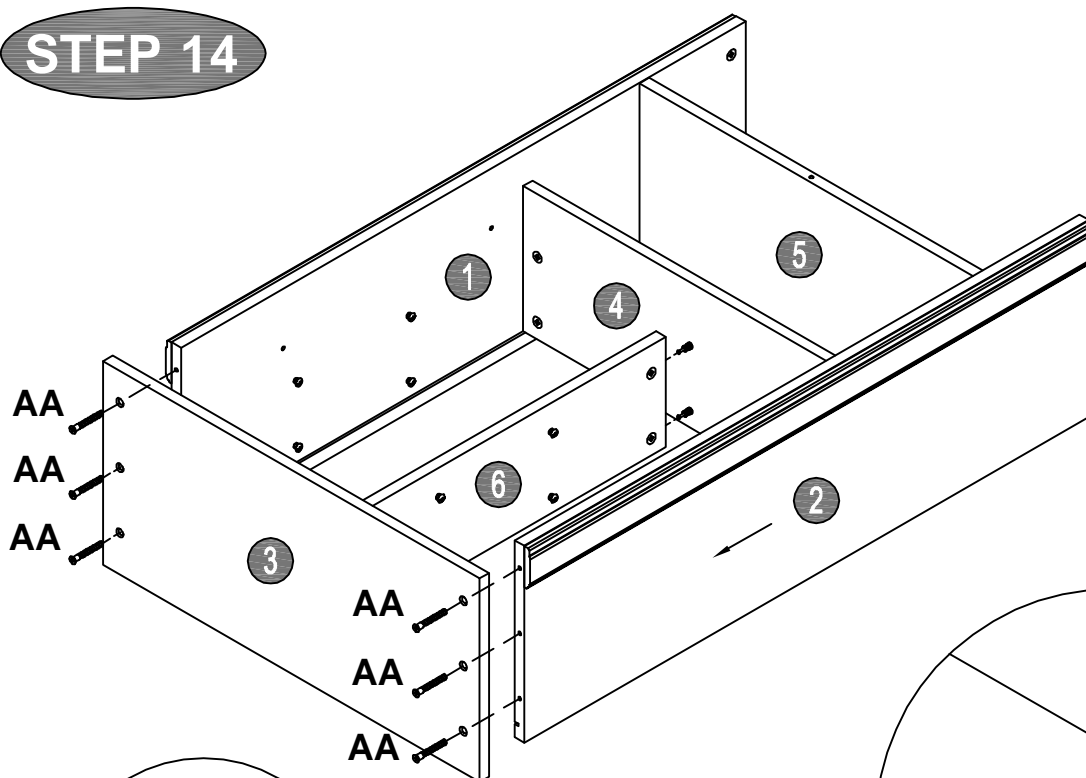

STEP 15

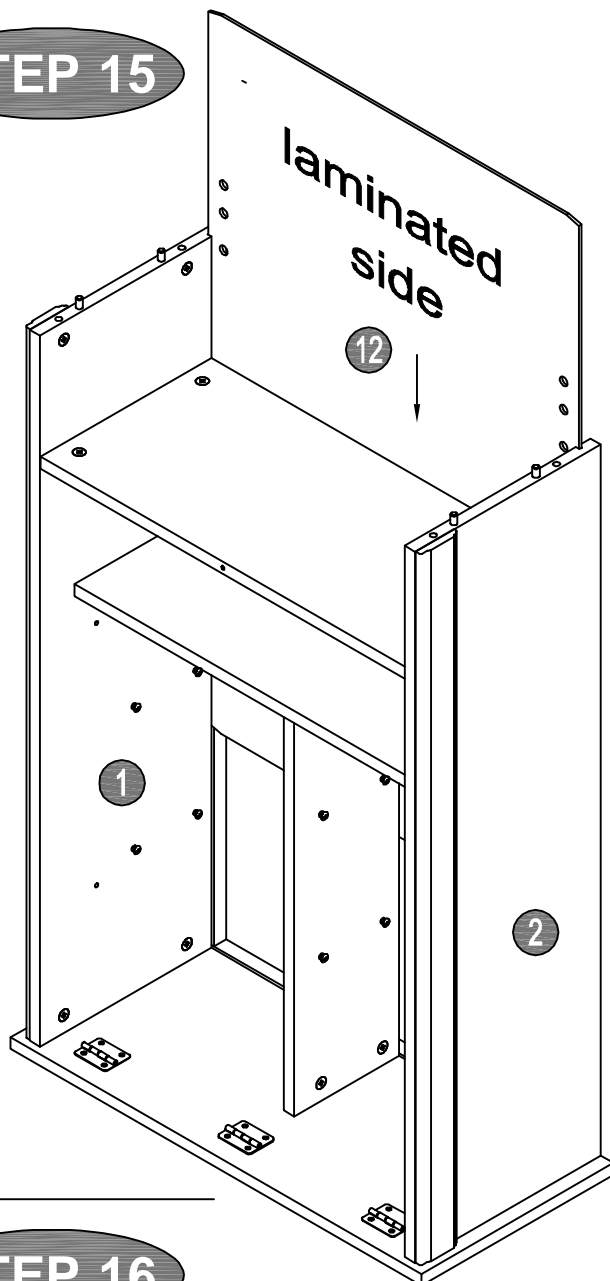

STEP 16

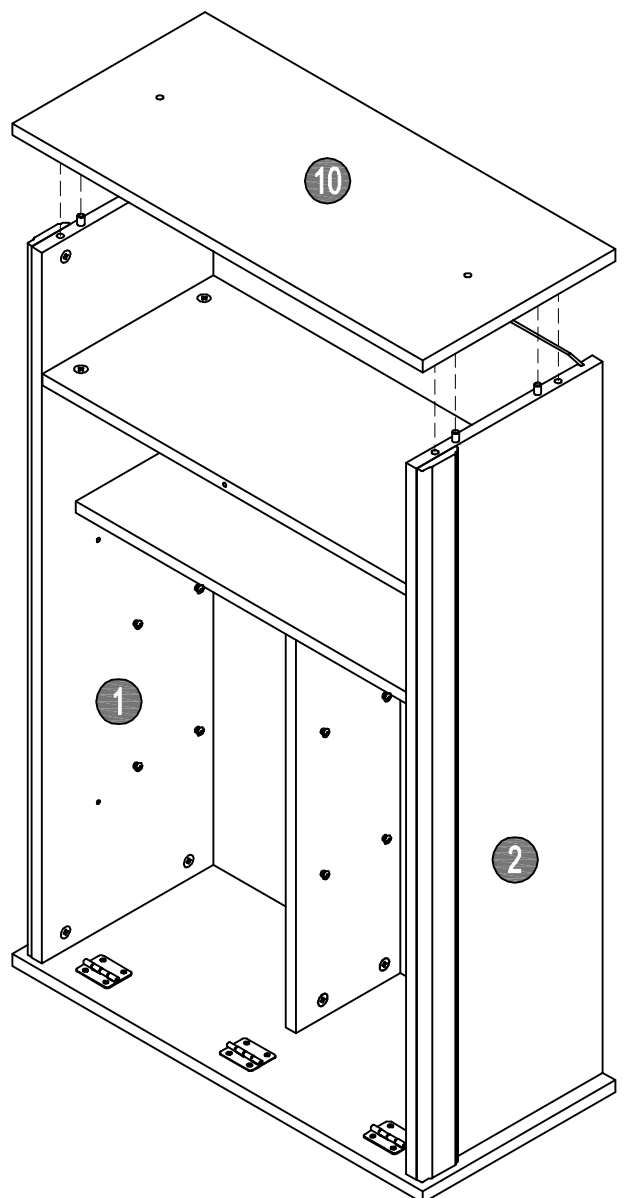
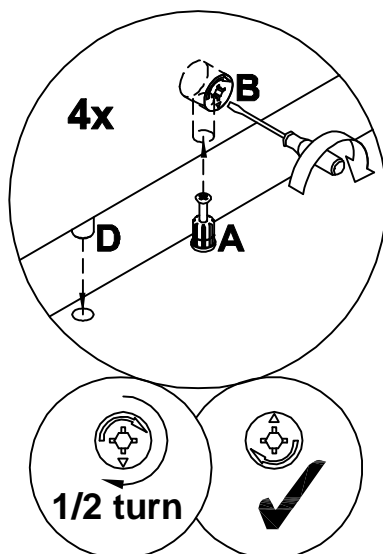

STEP 17

$L1=L2$



8x
E
HOLDER



8x
3x20mm
F
SCREW

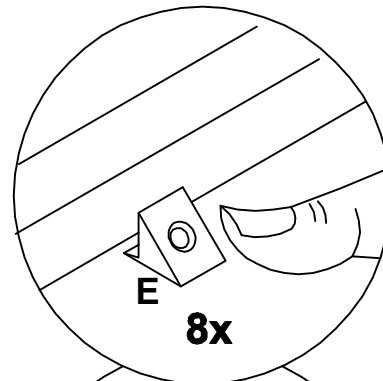
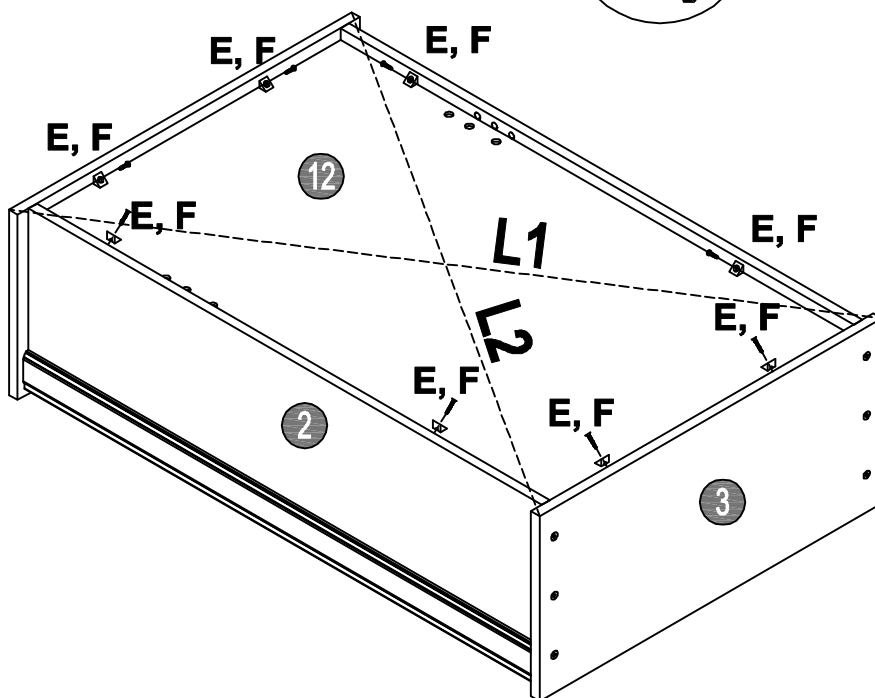

8x

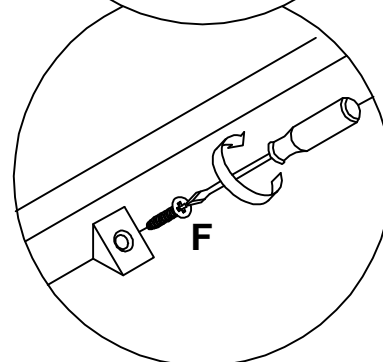

STEP 18

4x
3x20mm
F
SCREW



1x
G
SUSPENSION BRACKET



1x
H
SUSPENSION BRACKET

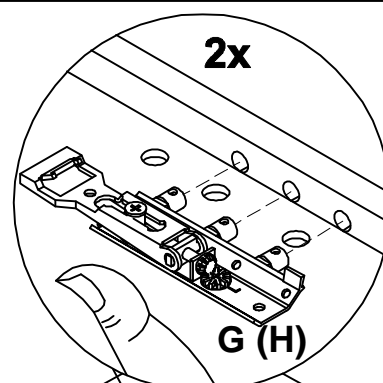
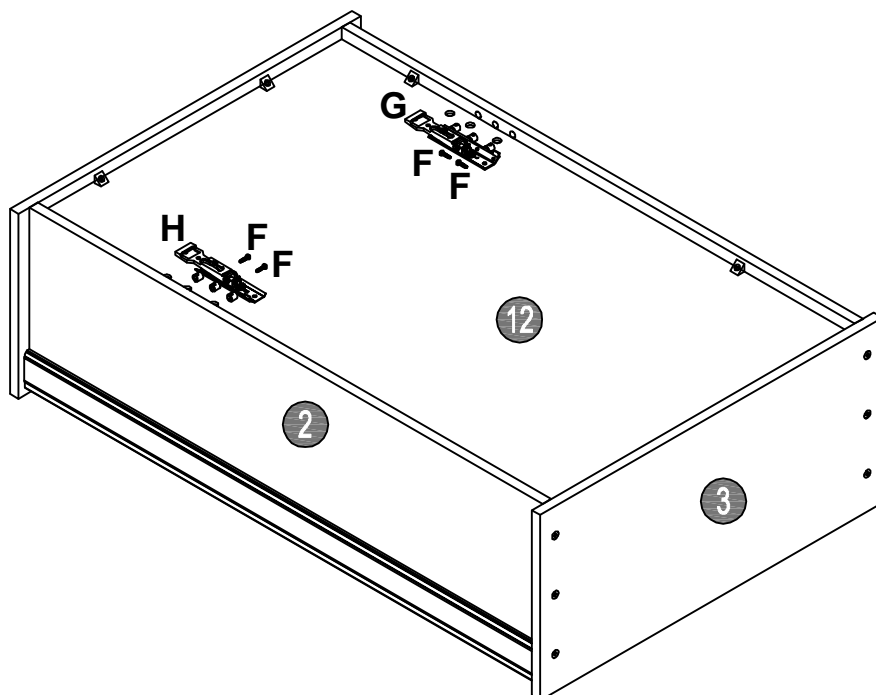

2x

G (H)

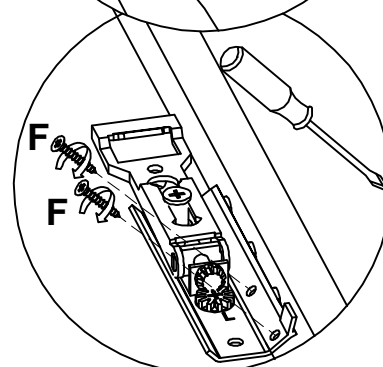

STEP 19

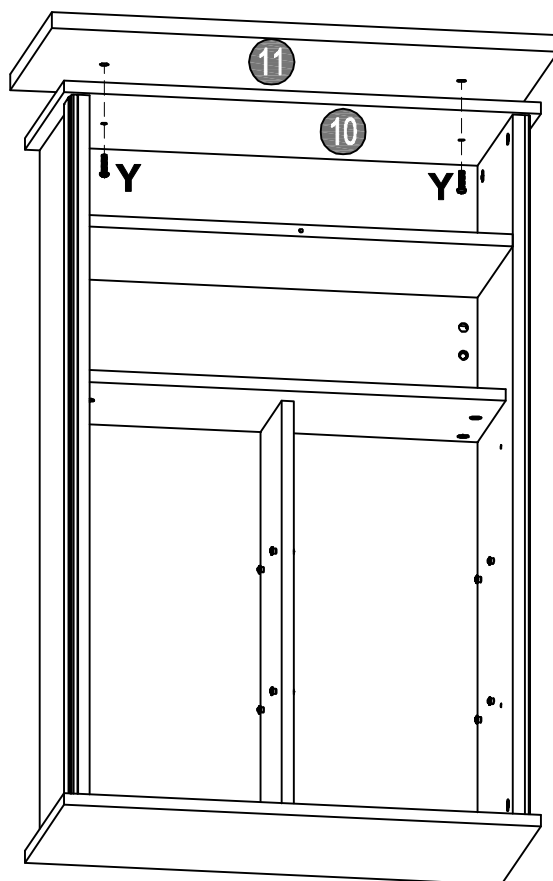

2x
M6x25mm
Y
BOLT

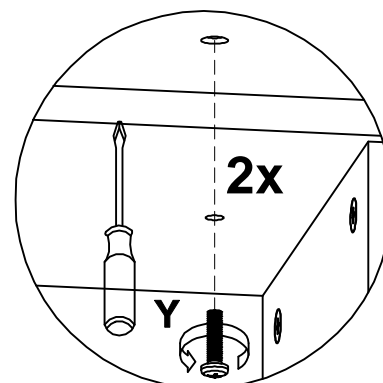

STEP 20

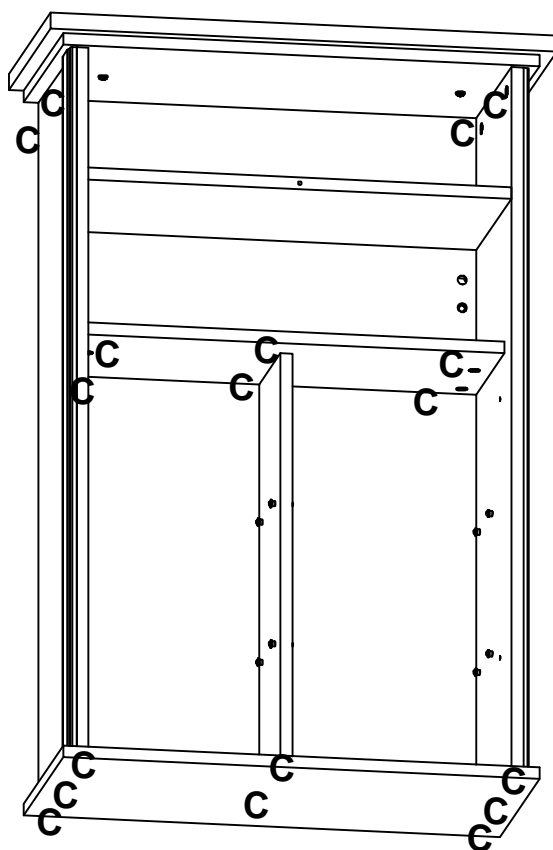

18x
D20mm
C
CAM LOCK COVER

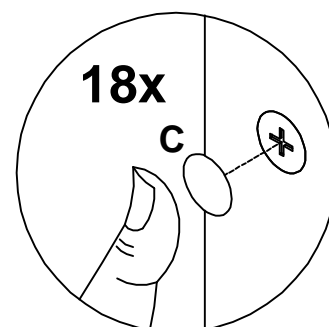

STEP 21

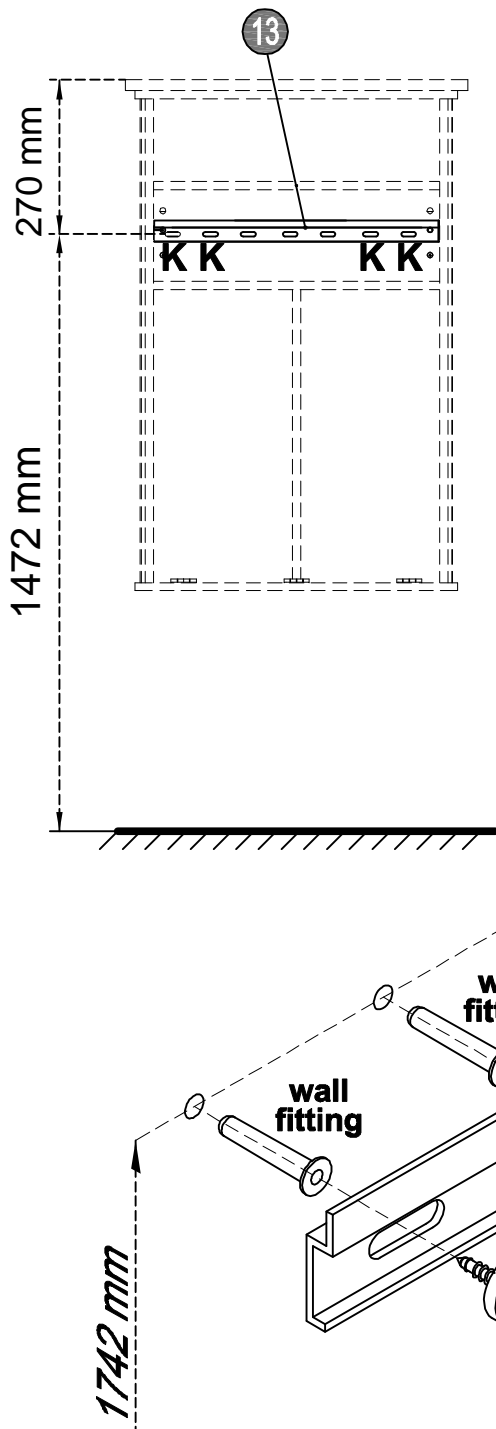

4x
5x45mm
K
SCREW

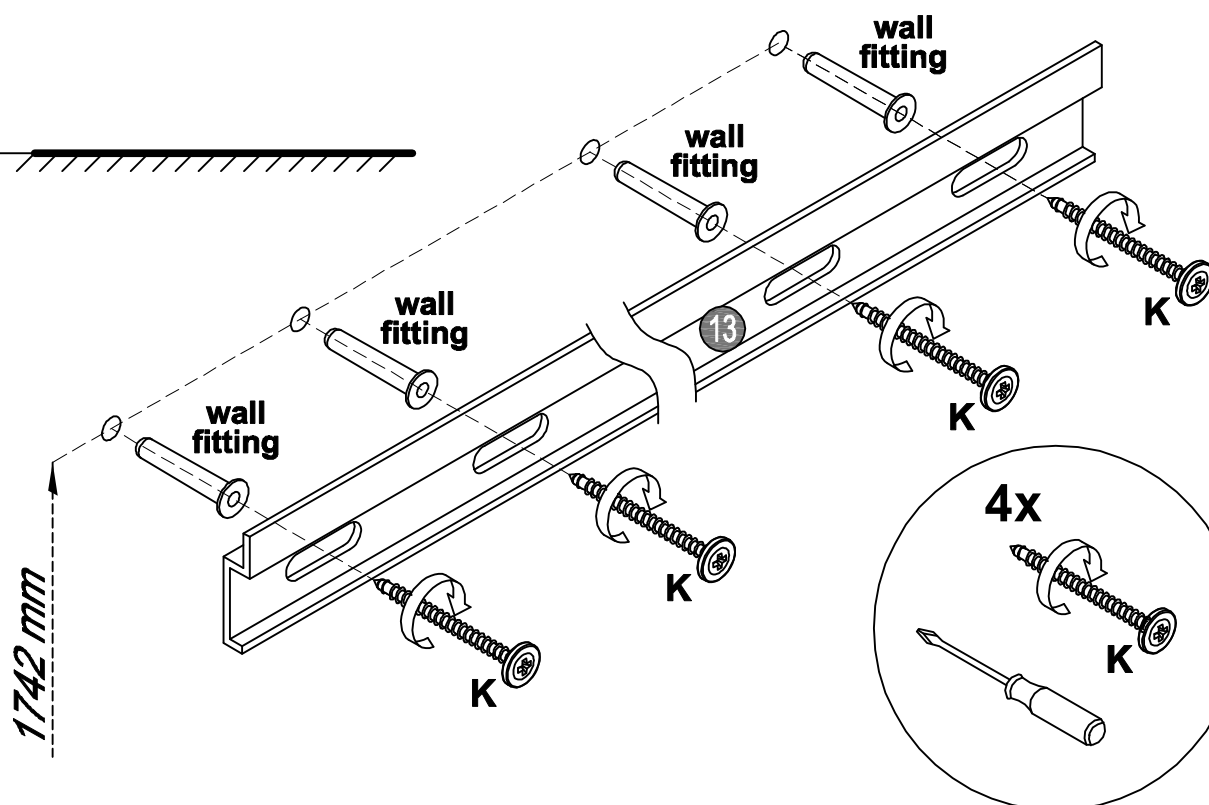
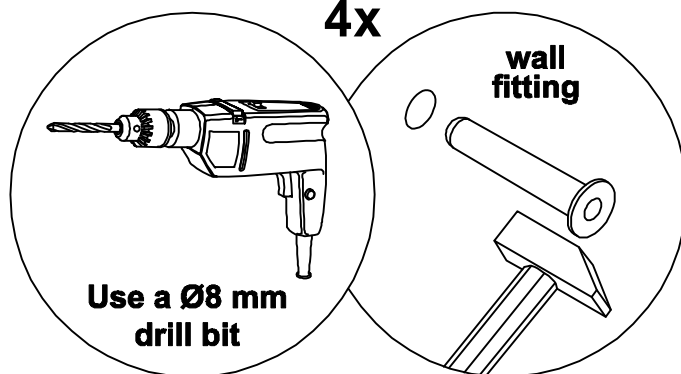

Wall fixings are not supplied with this product as different wall materials require different types of fixing devices (such as Rawl plugs used on brick work). You **must use** fixing devices suitable for the type of wall you intend to mount this product to.

Please ensure that the head of any screw used has a diameter greater than the diameter of the mounting hole on the product and that the fixing is safe and secure before use.

STEP 22

13

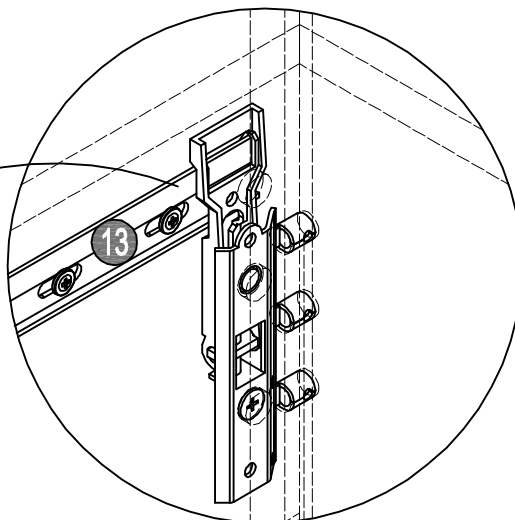
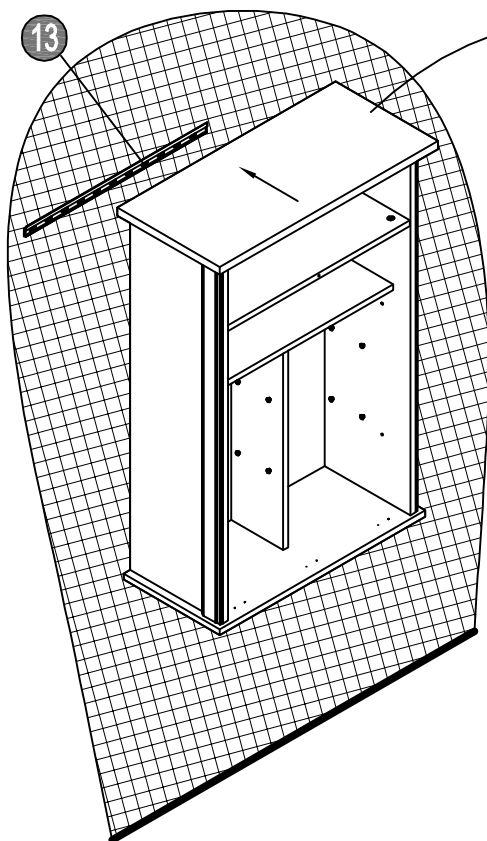

2x
M4x10mm
BOLT

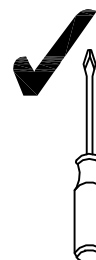
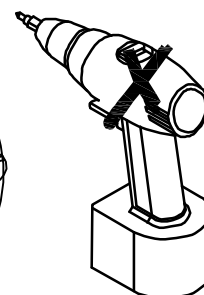
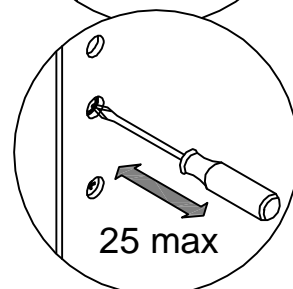
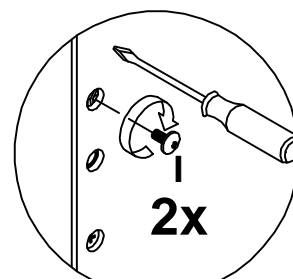
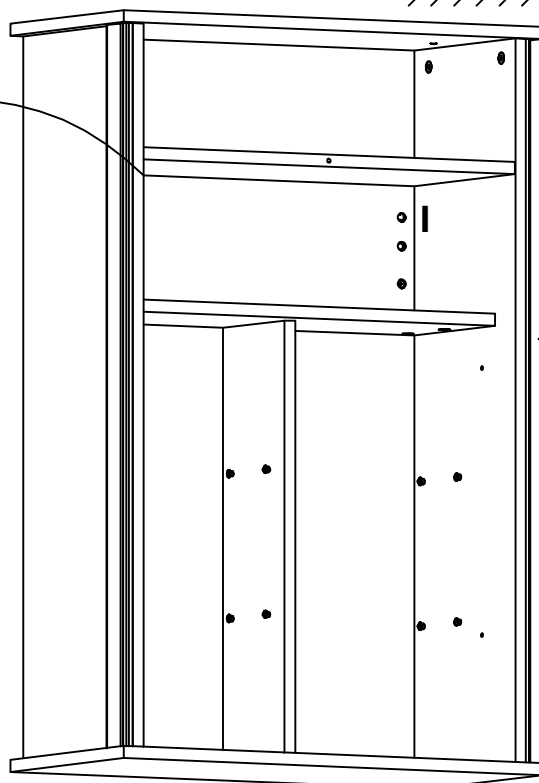
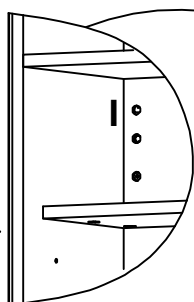
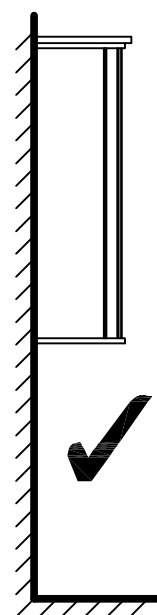
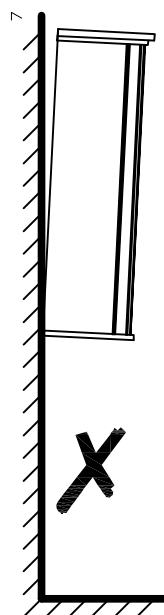
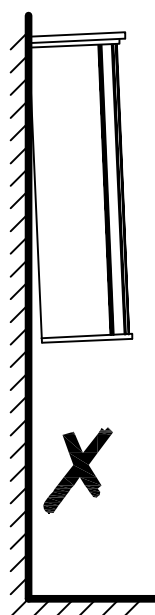

STEP 23

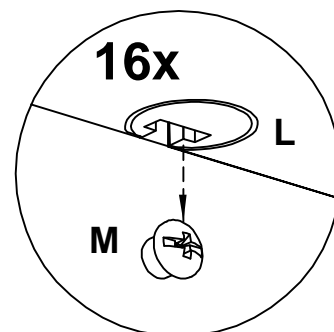
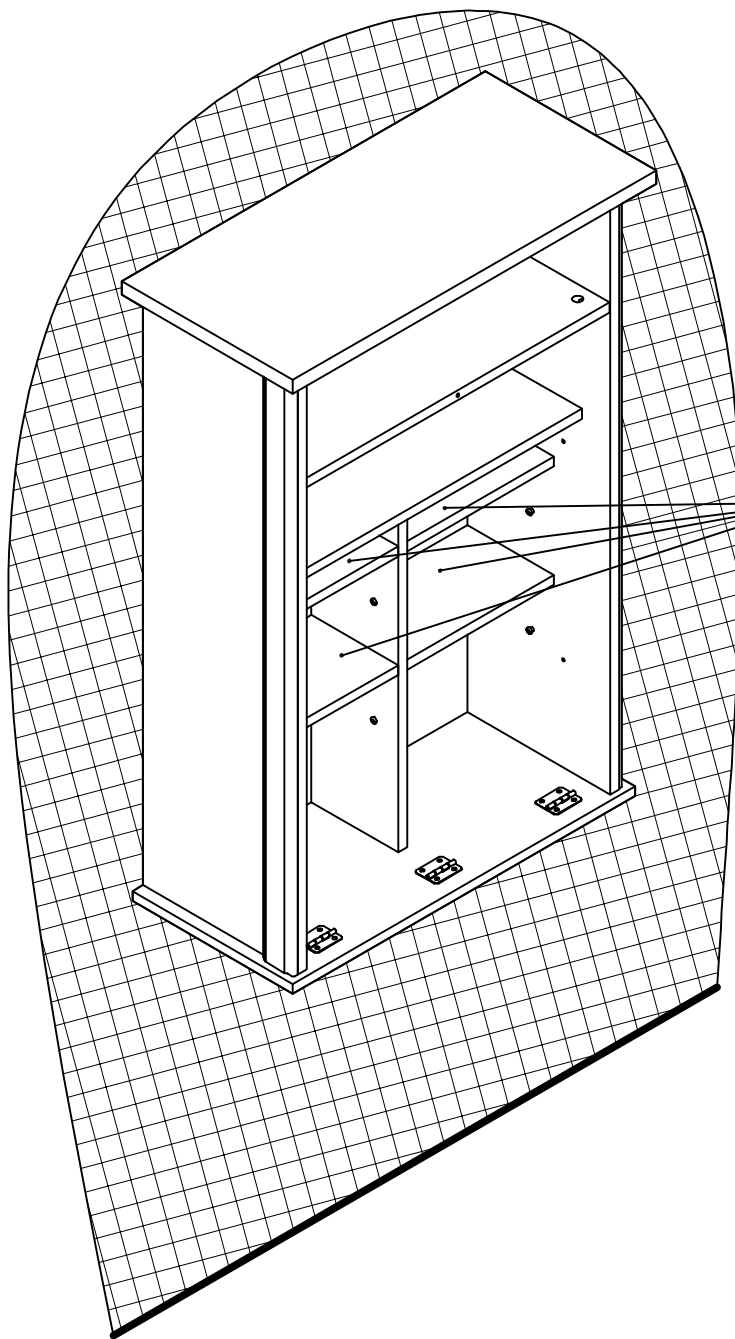

STEP 24

6x
3.5x16mm
O
SCREW

O
2x
S
BUMPER

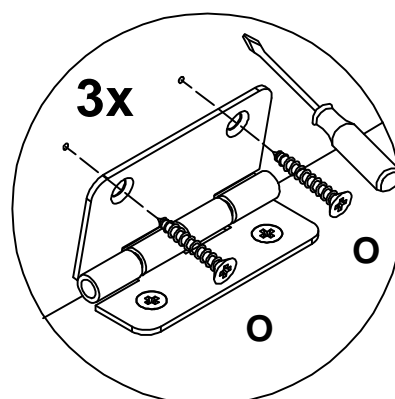
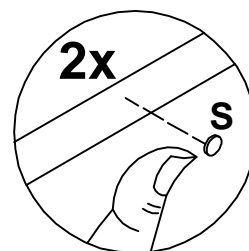
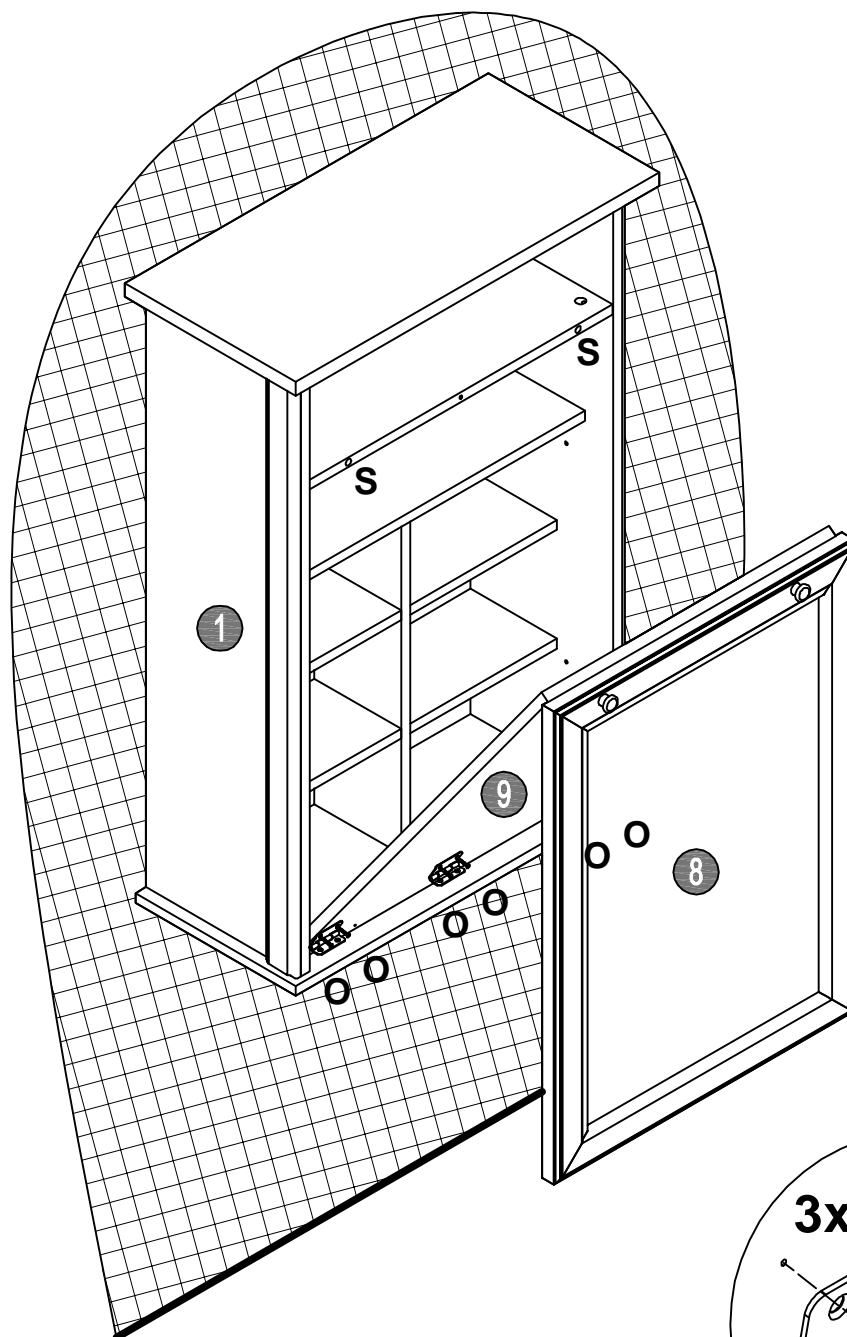

STEP 25



6x
D20mm
C
CAM LOCK COVER

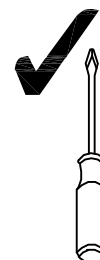
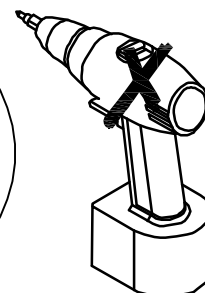
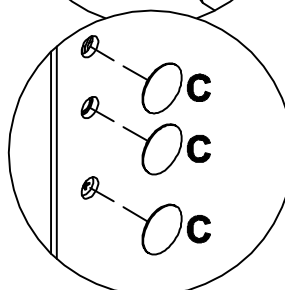
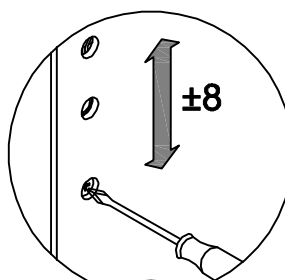
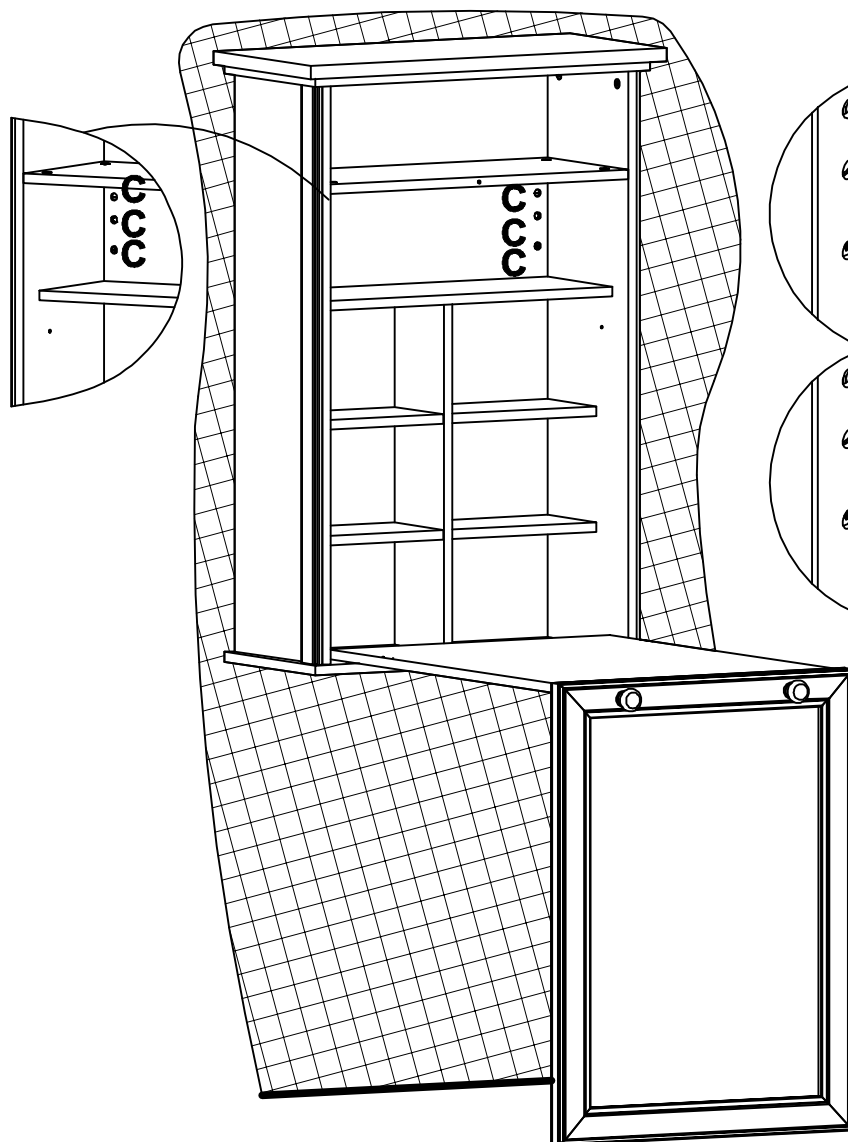
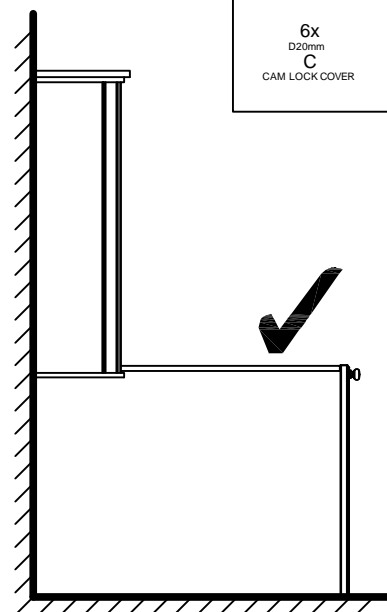
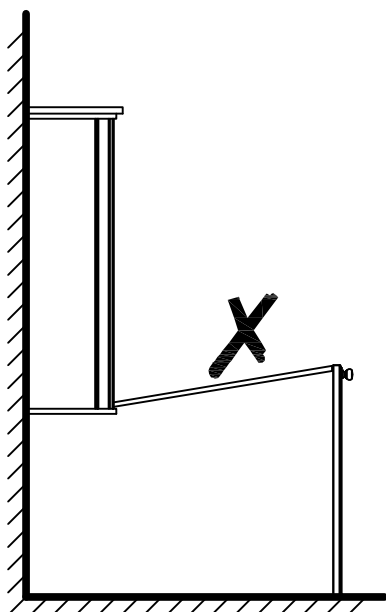
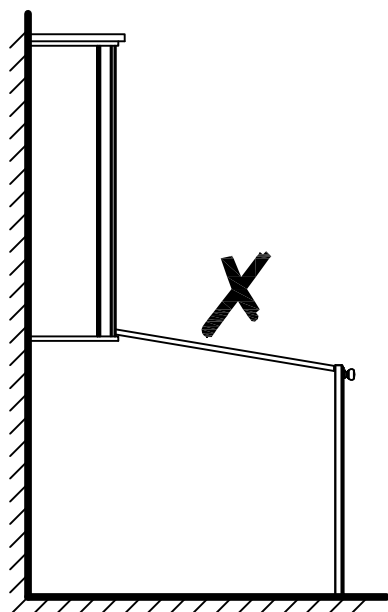

STEP 26

4x
4x20mm
J
SCREW

6x
3.5x16mm
O
SCREW

1x
Z
FLAP STAY

1x
Z1
FLAP STAY

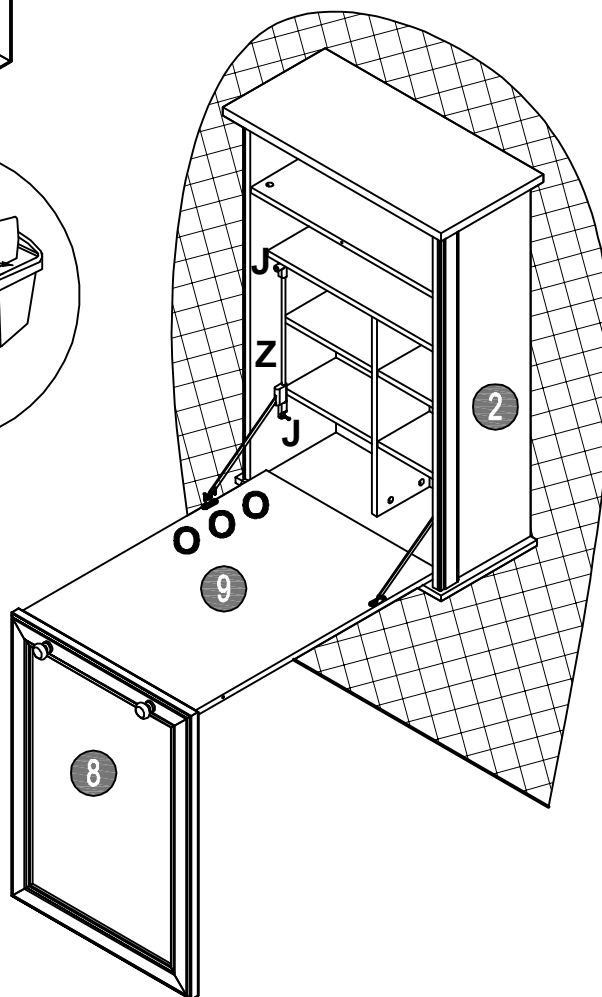
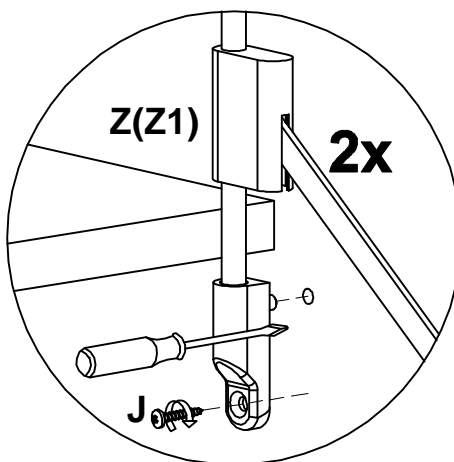
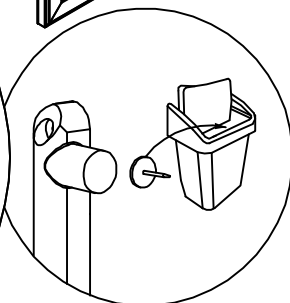
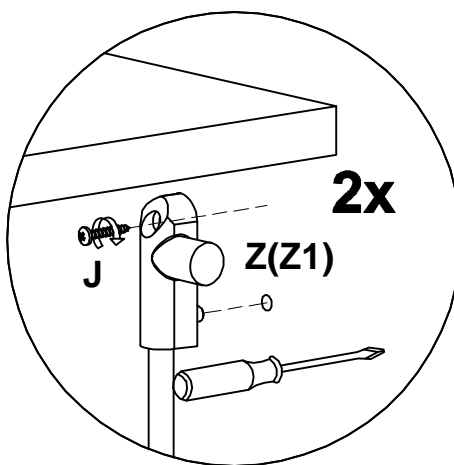
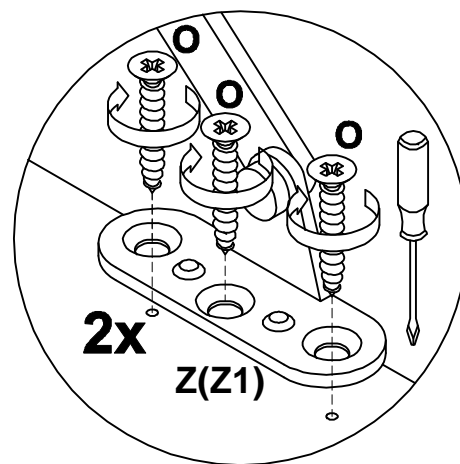
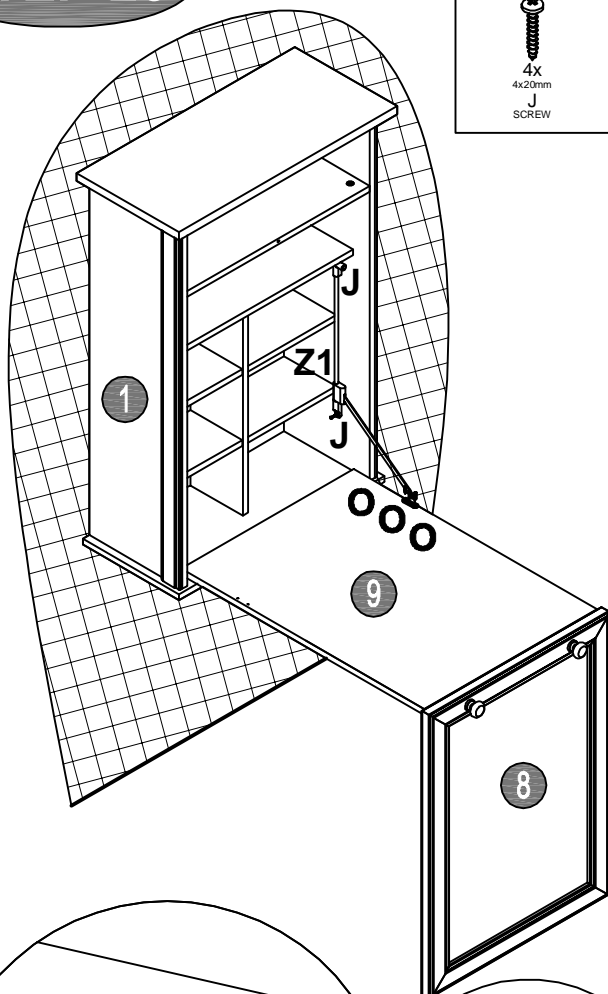

STEP 27

1x
3.5x16mm
O
SCREW

1x
T
HOOK

1x
U
WASHER

