

**INSTALLATION OF A PLUG
APPLICABLE TO U.K. AND IRELAND.**

This appliance is fitted with either a moulded or rewirable BS1363, 13 amp plug. The fuse should be ASTA approved to BS1362.

If the fuse in a moulded plug needs to be changed, the fuse cover must be refitted. The appliance must not be used without the fuse cover fitted. If the plug is unsuitable, it should be dismantled and removed from the supply cord and an appropriate plug fitted as detailed below. If you remove the plug it must not be connected to a 13 amp socket and the plug must be disposed of immediately.

The wires of the mains lead are coloured in accordance with the following code:
BLUE – NEUTRAL BROWN – LIVE

The wire which is coloured Blue, must be connected to the terminal which is marked with the letter N or coloured Black.

The wire which is coloured Brown, must be connected to the terminal which is marked with the letter L or coloured Red.

CAUTION: DO NOT CONNECT EITHER WIRE TO THE EARTH TERMINAL IN THE PLUG WHICH IS MARKED E OR WITH THE EARTH SYMBOL (⏏) OR COLOURED GREEN OR GREEN AND YELLOW.

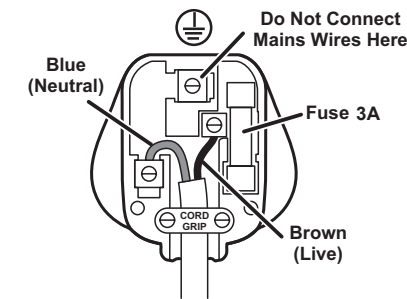

GUARANTEE

Please keep your receipt as this will be required for any claims under this guarantee.

This appliance is guaranteed for 3 years after your purchase as described in this document. During this guaranteed period, if in the unlikely event the appliance no longer functions due to a design or manufacturing fault, please take it back to the place of purchase, with your till receipt and a copy of this guarantee.

The rights and benefits under this guarantee are additional to your statutory rights, which are not affected by this guarantee. Only

Jarden Consumer Solutions (Europe) Limited ("JCS (Europe)") has the right to change these terms.

JCS (Europe) undertakes within the guarantee period to repair or replace the appliance, or any part of appliance found to be not working properly free of charge provided that:

- you promptly notify the place of purchase or JCS (Europe) of the problem; and
- the appliance has not been altered in any way or subjected to damage, misuse, abuse, repair or alteration by a person other than a person authorised by JCS (Europe).

Faults that occur through, improper use, damage, abuse, use with incorrect voltage, acts of nature, events beyond the control of JCS (Europe), repair or alteration by a person other than a person authorised by JCS (Europe) or failure to follow instructions for use are not covered by this guarantee. Additionally, normal wear and tear, including, but not limited to, minor discoloration and scratches are not covered by this guarantee.

The rights under this guarantee shall only apply to the original purchaser and shall not extend to commercial or communal use.

If your appliance includes a country-specific guarantee or warranty insert please refer to the terms and conditions of such guarantee or warranty in place of this guarantee or contact your local authorized dealer for more information.

This marking indicates that this product should not be disposed with other household wastes throughout the EU. To prevent possible harm to the environment or human health from uncontrolled waste disposal, recycle it responsibly to promote the sustainable reuse of material resources.

To return your used device, please use the return and collection systems or contact the retailer where the product was purchased. They can take this product for environmental safe recycling.

Jarden Consumer Solutions (Europe) Limited
Middleton Road
Royton
OL2 5LN
UK

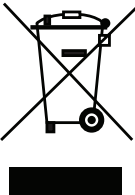

**Jarden Consumer Solutions (Europe) Limited
Royton, Oldham OL2 5LN
England**

Fax: +44 (0)20 8947 8272

Email: enquiriesEurope@jardencs.com

UK - Filter Sales Order Line - 0870 759 9000

Website address: www.bionaire.com

UK - Free phone Customer Service Helpline – 0800 052 3615



© 2013 Sunbeam Products, Inc. doing business as Jarden Consumer Solutions. All rights reserved. Distributed by Jarden Consumer Solutions (Europe) Limited, Middleton Road, Royton OL2 5LN, United Kingdom.
Printed in PRC

BASF1516_Rev1 07/13

93631-0
P.N. 172231



pure indoor living



2-IN-1 DUAL DESK/STAND
FAN

MODEL: BASF1516

INSTRUCTION MANUAL

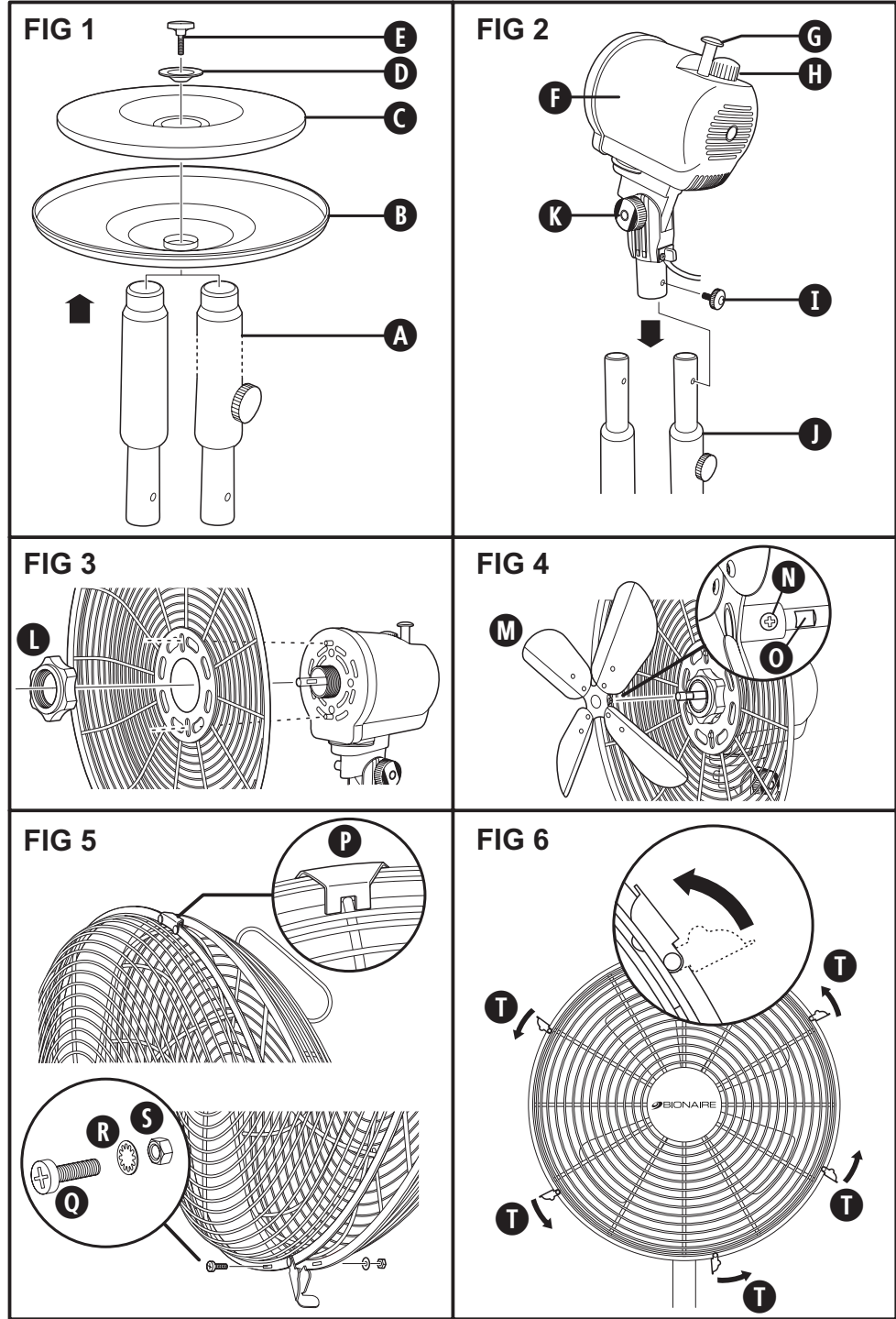

U.K. AND IRELAND

PLEASE READ AND SAVE THESE IMPORTANT SAFETY INSTRUCTIONS.

Carefully read and retain all instructions before using your 2-in-1 dual desk/stand fan.

This appliance is not intended for use by persons (including children) with reduced physical, sensory or mental capabilities, or lack of experience and knowledge, unless they have been given supervision or instruction concerning use of the appliance by a person responsible for their safety. Children should be supervised to ensure that they do not play with the appliance.

Unplug from the electrical outlet when not in use, when moving the fan from one location to another, before putting on or taking off any parts and before cleaning.

If the supply cord or plug is damaged, it must be replaced by the manufacturer or its service agent or a similarly qualified person in order to avoid hazard.

- To protect against electrical shock, do not immerse the fan, plug or cord in water or spray with liquids.
- Avoid contact with any moving parts.
- Do not operate in the presence of explosive and/or flammable fumes.
- Do not operate fan until fully assembled with all parts properly in place.
- To avoid fire hazard, NEVER place the cord under rugs or any parts near an open flame, cooking or other heating appliance.
- Do not use outdoors.
- Do not let the cord hang over the edge of a table or counter, or come into contact with hot surfaces.
- To disconnect from the electrical supply, grip the plug and pull from the wall outlet. DO NOT pull on the cord.
- Always use on a dry, level surface.
- Do not operate your fan unless the fan grilles are properly fitted.
- This product is intended for household use ONLY and not for commercial or industrial applications.

- Should the fan stop working, first check the fuse in the plug (UK only) or fuse/circuit breaker at the distribution board is operating, before contacting the manufacturer or service agent.

MISSING A PART FOR YOUR FAN?

Please call 0800 052 3615 for assistance.

ASSEMBLY INSTRUCTIONS

Base/pole assembly (FIG 1)

Your fan can be used as a desk fan or a floor fan. It is supplied with two poles; an adjustable pole for floor use and a short, fixed pole for desktop use.

1. Select either the adjustable pole or short pole **A**.
2. Turn the pole upside down and insert the end of the pole through the decorative base cover **B**.
3. Fit the weight **C** and conical washer **D** over the end of the pole as shown.
4. Screw the T-shaped locking bolt **E** into the end of the pole as shown and tighten firmly.
5. Set the base on the floor, weight side down.

Fan head assembly (FIG 2)

1. Place the fan head assembly **F** onto the pole.
2. Align the hole in the fan head with the hole in the pole and secure the fan head using the locking knob **I** tightening firmly.

NOTE: The fan head locking knob **I** may be fitted to the short pole when shipped.

Rear grille assembly (FIG 3)

1. Unscrew the grille mounting nut **L** from the fan head. Position the rear grille over the motor shaft making sure that the vertical slots in the top and bottom of the rear grille fit over the two prongs on the front of the fan head. Make sure that the carry handle on the rear grille is at the top.
2. Secure the rear grille using the grille mounting nut **L** and tighten firmly.

Fan blade assembly (FIG 4)

CAUTION: The fan blades might have sharp edges. Handle with care.

1. Loosen the securing screw **N** and slide the fan blade **M** onto the motor shaft. The motor shaft may be covered with a protective plastic sleeve. Remove and discard the sleeve before fitting the fan blade.

2. Make sure securing screw **N** aligns with the notch **O** on the motor shaft and tighten it firmly.

Front grille assembly (FIG 5)

NOTE: Parts **O**, **R** and **S** are fitted to the front grille for shipping purposes. Remove and discard the clear plastic tube.

1. Position the front grille with the BIONAIRE™ logo the right side up and hook the bracket **P** over the rim of the rear grille as shown. When correctly fitted, the bracket will straddle the central wire of the rear grille.
2. Align the slot in the bottom rim of of the front grille with the corresponding slot in the rear grille.
3. Fit the screw **Q** through the slots.
4. Fit the washer **R** over the screw and then fit the nut **S** and tighten firmly.

Final assembly (FIG 6)

1. Rotate the five grille clips **T** as shown making sure that they go over both front and rear grille rims.

OPERATING INSTRUCTIONS

1. Set your fan on a dry, level surface
2. Make sure the speed control (**H** FIG 2) is in the off (0) position.
3. Plug your fan into a suitable mains outlet socket.
4. Select the desired speed using the speed control (1, 2 or 3).
5. If desired, you can set your fan to swing slowly backwards and fowards using the oscillation knob (**G** FIG 2). To start oscillation, push the knob downwards. To stop, pull the knob upwards.

ADJUSTMENTS

Tilt adjustment

To adjust the tilt of your fan, loosen the tilt head adjustment knob (**K** FIG 2), adjust your fan to the desired tilt angle then tighten the knob.

Height adjustment (adjustable pole only)

1. Loosen the adjustable pole locking knob.
2. Adjust the pole to the desired height then firmly tighten the locking knob.

CLEANING AND MAINTENANCE

Follow these instructions to correctly and safely care for your Bionaire™ fan. Please remember:

- Always unplug the fan before cleaning or assembly.
- Do not allow water to drip onto or into the fan head.
- Be sure to use a soft cloth, moistened with a mild soap solution.
- Do not use any of the following as a cleaner: petrol, thinners or benzene.

Fan blade cleaning

1. To access the fan blade, remove the front grille by opening the five clips **T** and removing the securing screw **Q**, nut **S** and washer **R**.
2. Loosen the fan blade securing screw **N** and remove the fan blade from the motor shaft.
3. Clean the fan blade, and front and rear grilles with a soft moist cloth.
4. Replace the fan blade as described under Fan blade assembly.
5. Refit the front grille as described under Front grille assembly and Final assembly.

Fan head, base and pole cleaning

Carefully clean the fan base, pole and fan head using a soft, moist cloth, with or without a mild soap solution. Please use caution around the motor housing area. Do not allow the motor or other electrical components to become exposed to water.

FAN STORAGE

Your fan can be stored either partially disassembled or assembled.

It is important to keep it in a safe, dry location.

- If stored disassembled, we recommend using the original or an appropriately sized box.
- If stored assembled or partially assembled, remember to protect the fan head from dust.