

#### FOR U.K. AND IRELAND ONLY

If the plug is not suitable for the socket outlets in your home, it can be removed and replaced by a plug of the correct type. Please refer to "Installation of a plug" below.

#### Installation of a plug applicable to U.K. and Ireland

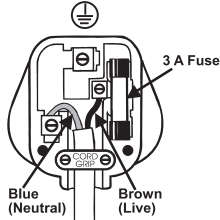

**NOTE:** If the terminals in the plug are not marked or if you are unsure or in doubt about the installation of the plug please contact a qualified electrician.

If a 13A 3-pin plug is fitted, it must be an ASTA approved plug, conforming to BS1363 standard. Replacement 3A fuses must be BSI or ASTABS1362 approved.

This product is fitted with a 13A plug complying to BS1363. If this plug is unsuitable or needs to be replaced, please note the following: The wires in the mains lead are coloured as such:

BROWN - LIVE  
BLUE - NEUTRAL

Please note that the colour of these mains wires may not correspond with the colour markings that identify the terminals in your plug. Please proceed as follows:

The BROWN coloured wire must be connected to the terminal, which is marked with the letter "L" or is coloured RED.

The BLUE coloured wire must be connected to the terminal, which is marked with the letter "N" or is coloured BLACK.

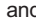
DO NOT CONNECT either of these wires to the earth terminal in the plug. The earth terminal plug is marked with the letter "E", or with the earth symbol , or coloured GREEN, or GREEN and YELLOW.

#### TECHNICAL SPECIFICATION

For all Technical and Regulatory information with regards to your product specifications under Eco-Design Regulation No 206/2012, please contact the manufacturer. Full details including fan flow rate, fan power input, standby power and max air velocity of your Bionaire® Fan can be provided. Please contact our consumer help line or visit [www.bionaire.co.uk](http://www.bionaire.co.uk).

#### GUARANTEE

Please keep your receipt as this will be required for any claims under this guarantee.

This appliance is guaranteed for 3 years after your purchase as described in this document. During this guaranteed period, if in the unlikely event the appliance no longer functions due to a design or manufacturing fault, please take it back to the place of purchase, with your till receipt and a copy of this guarantee.

The rights and benefits under this guarantee are additional to your statutory rights, which are not affected by this guarantee. Only Holmes Products (Europe) Ltd. ("Holmes") has the right to change these terms.

Holmes undertakes within the guarantee period to repair or replace the appliance, or any part of appliance found to be not working properly free of charge provided that:

- you promptly notify the place of purchase or Holmes of the problem; and
- the appliance has not been altered in any way or subjected to damage, misuse, abuse, repair or alteration by a person other than a person authorised by Holmes.

Faults that occur through, improper use, damage, abuse, use with incorrect voltage, acts of nature, events beyond the control of Holmes, repair or alteration by a person other than a person authorised by Holmes or failure to follow instructions for use are not covered by this guarantee. Additionally, normal wear and tear, including, but not limited to, minor discoloration and scratches are not covered by this guarantee. The rights under this guarantee shall only apply to the original purchaser and shall not extend to commercial or communal use.

If your appliance includes a country-specific guarantee or warranty insert please refer to the terms and conditions of such guarantee or warranty in place of this guarantee or contact your local authorized dealer for more information.

This marking indicates that this product should not be disposed with other household wastes and should be disposed separately throughout the EU. To prevent possible harm to the environment or human health from uncontrolled waste disposal due to the presence of hazardous substances within the product, recycle it responsibly to promote the sustainable reuse of materials and resources. To return your used device, please use the return and collection systems available to you or contact the retailer where the product was purchased. They can take this product for environmentally safe recycling. Holmes Products (Europe) Limited

1 Francis Grove  
London  
SW19 4DT  
UK



Holmes Products (Europe) Ltd.  
1 Francis Grove  
London SW19 4DT  
England

Fax: +44 (0)20 8947 8272

Email: [enquiriesEurope@jardencs.com](mailto:enquiriesEurope@jardencs.com)

UK - Filter Sales Order Line - 0870 759 9000

Website address: [www.bionaire.com](http://www.bionaire.com)

UK - Free phone Customer Service Helpline – 0800 052 3615



© 2012 Sunbeam Products, Inc. doing business as Jarden Consumer Solutions. All rights reserved.

Distributed by Holmes Products (Europe) Ltd., 1 Francis Grove, London SW19 4DT, United Kingdom. Printed in PRC

GCDS-BIO26556-ZZ

BASF1016GRC-IUK\_12EM1

P.N. 161681



## DOUBLE BLADE STAND FAN

WITH REMOTE CONTROL

MODEL: BASF1016GRC

## INSTRUCTION MANUAL

## BASF1016GRC

Figure 1

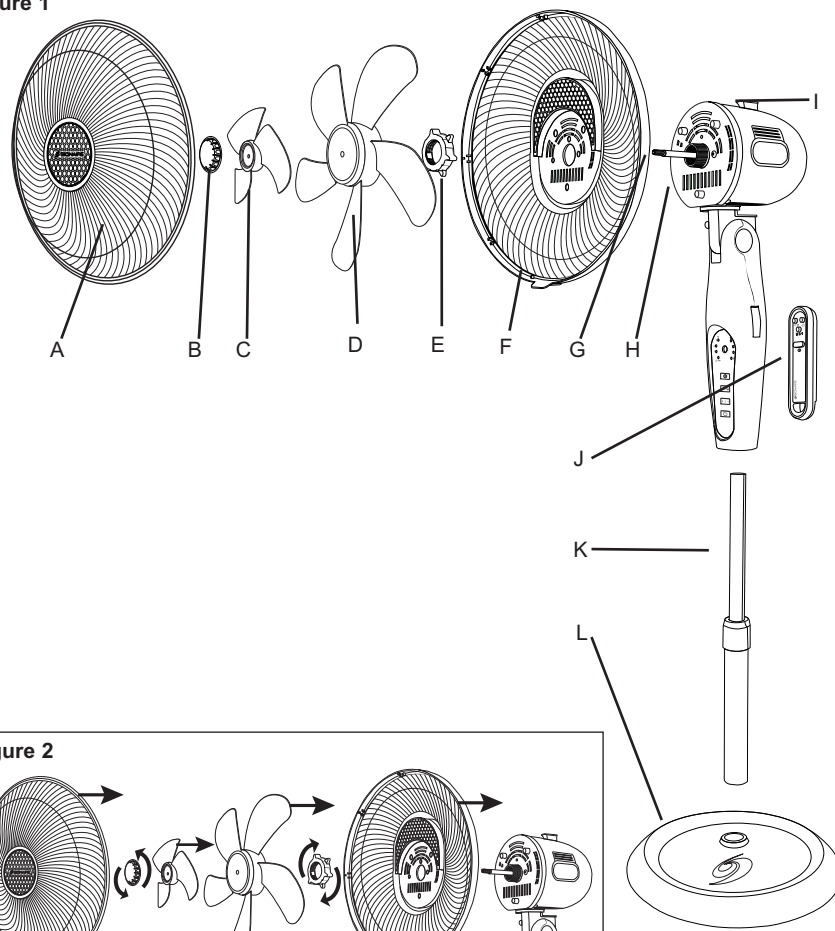

Figure 2

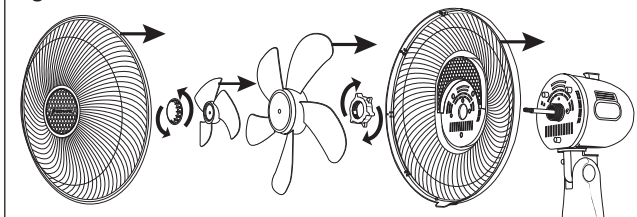

Figure 3

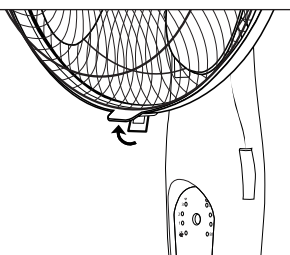
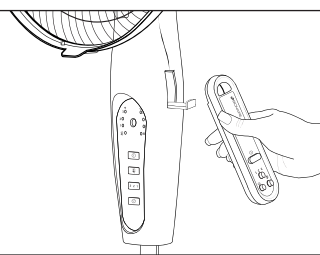

Figure 4



## ENGLISH

**PLEASE READ AND SAVE THESE INSTRUCTIONS****IMPORTANT INSTRUCTIONS**

When using electrical appliances, basic safety precautions should always be taken including the following:-

- Use the fan only for purposes described in the instruction manual.
- To protect against electrical shock, do not immerse the fan, plug or cord in water or spray with liquids.
- Close supervision is necessary when any appliance is used by or near children.
- Unplug from the electrical outlet when not in use, when moving the fan from one location to another, before putting on or taking off parts and before cleaning.
- Avoid contact with any moving parts.
- Do not operate in the presence of explosive and/or flammable fumes.
- Do not operate fan until fully assembled with all parts properly in place.
- To avoid fire hazard, NEVER place the cord under rugs or any parts near an open flame, cooking or other heating appliance.
- Ensure that the fan is switched off from the supply mains before removing the guard.
- Do not operate any appliance with a damaged cord, plug, after the appliance malfunctions, or has been dropped/damaged in any manner.
- The use of attachments not recommended or sold by the appliance manufacturer may cause hazards.
- Do not use outdoors.
- Do not let the cord hang over the edge of a table or counter, or come into contact with hot surfaces.
- To disconnect from the electrical supply, grip the plug and pull from the wall outlet. DO NOT pull on the cord.
- Always use on a dry, level surface.
- Do not operate without the fan grills properly in place.
- This product is intended for household use ONLY and not for commercial or industrial applications.
- Should the fan stop working, first check the fuse in the plug (UK only) or fuse/circuit breaker at the distribution board is operating, before contacting the manufacturer or service agent.
- If the supply cord or plug is damaged, it must be replaced by the manufacturer or its service agent or a similarly qualified person in order to avoid hazard.

- This appliance is not intended for use by persons (including children) with reduced physical, sensory or mental capabilities, or lack of experience and knowledge, unless they have been given supervision or instruction concerning use of the appliance by a person responsible for their safety. Children should be supervised to ensure that they do not play with the appliance.

**DESCRIPTIONS**

See Figure 1

- A. Front Grill
- B. Fan Blade Lock Nut
- C. Small Fan Blade
- D. Large Fan Blade
- E. Rear Grill Nut
- F. Rear Grill
- G. Motor Shaft
- H. Motor Housing
- I. Oscillation Button
- J. Remote Control
- K. Expandable Pole
- L. Base

**MISSING A PART FOR YOUR FAN?**

Please call 0800 052 3615 for assistance.

**BASE POLE ASSEMBLY**

1. Extend the upper pole through the top of the lower pole and secure it firmly by turning the height adjust knob clockwise.
2. Insert the bottom of the lower pole into the hole on the top of the base.

**FAN HEAD ASSEMBLY**

You are now ready to assemble the fan head.

- 1: Position the rear grill over the motor shaft, making certain the 3 notches at the top and bottom of the rear grill fit over the 3 protruding notches on the motor housing. Make sure the rear grill fits securely against the motor housing. (Figure 2)
- 2: Fasten the rear grill in place using the rear grill nut. Turn the nut clockwise and tighten firmly. (Figure 2)
- 3: Slide the large fan blade, with the hollowed interior of the fan blade facing toward the rear grill, firmly onto the motor shaft. Then install the small fan blade. The blades have a "D" type hole that matches the tip of the motor shaft. These two should be aligned so that the blades can be properly assembled. Make sure that the fan blades rest on the pin on the motor.
- 4: Secure the fan blades onto the motor shaft by turning the fan blade lock nut counter-clockwise (make sure the blades are firmly in position). (Figure 2)

**NOTE:** The shaft screw portion should protrude from the front of the blades.

5. Center the front grill, aligning the Bionaire® logo so it is horizontal and parallel to the floor. Put onto the rear grill and snap in place. Make sure to secure the locking-clip on the bottom of the rear grill. (Figure 3) You should hear a click.

**Final Assembly**

1. Insert the fan head assembly into the pole/base assembly. The placement is done by a secure press fit that tightens the assembly in place so the fan head should be slightly pressed down.
2. Lower the remote control holder on the right side of the front control housing and place the hollow end of the remote control housing (female end) onto the remote control holder. (Figure 4)

**OPERATING INSTRUCTIONS**

1. Set fan on a dry, level surface.
2. Plug power cord into the appropriate outlet. The fan will make an audible sound, indicating it is plugged in.
3. Press the power button "⏻" to change the power status between on or off. The speed light of the last selection will light up.
4. The speed is adjustable by pushing the speed button "1 2 3" to cycle the speed mode into three speed levels: Speed 1, Speed 2, Speed 3. Press and hold speed button for more than 2 seconds to turn fan off. Your fan has a speed recall memory so the unit will remember the last speed used.  
Note: The fan will always turn on at speed 2 and then after two seconds it will cycle to the last speed recall.
5. If you would like to program the timer to set the number of hours you would like to keep the fan on, press the timer button "⌚" to select the timer setting into the following options: 1 hour, 2 hours, 4 hours, 8 hours.
6. To oscillate the fan head, push the oscillation button "↺↻" located at the top of the motor housing down to turn it on. To stop the oscillation, pull the oscillation button "↺↻" up.
7. To operate the breeze or sleep modes, press the button "🌬️". Pressing with the green light is for breeze mode. It randomly circulates through the speed settings to simulate a natural breeze. Pressing with the amber light is for sleep mode. It cycles through the speed settings in order. Pressing with no light is for off.

**REMOTE CONTROL HANDHELD UNIT**

- The remote includes control buttons for Power on/off "⏻", and Speed Selections "1 2 3", and Breeze/Sleep Modes "🌬️".
- The speed recall memories will also work with the remote control.
- Your remote control requires 2 AAA batteries (not included) for operation.
- Install the 2 AAA batteries in the rear compartment of the remote, according to the diagram shown inside.
- Do not mix old and new batteries.
- Do not mix alkaline, standard (carbon-zinc), or rechargeable (nickel-cadmium) batteries.

**ADJUSTMENT****Height Adjustment**

This fan is equipped with an expandable pole, which allows you to adjust the height of the fan according to your preference.

**Tilt Adjustment**

To change the tilting angle of the fan head, move the fan head manually to the desired angle.

**CLEANING AND MAINTENANCE**

Follow these instructions to correctly and safely care for your Bionaire® fan. Please remember:

- Always unplug the fan before cleaning or assembly.
- Do not allow water to drip on or into the fan motor housing.
- Be sure to use a soft cloth, moistened with a mild soap solution.
- Do not use any of the following as a cleaner: petrol, thinners or benzene.

**Fan Blade cleaning**

(See instructions for fan head assembly)

1. Carefully remove the front grill from the clips.
2. Clean the fan blades, front and rear grills with a soft moist cloth.
3. Replace the fan blades, tighten screw and securely fasten the front grill.

**Fan head, base and pole cleaning**

Using a soft, moist cloth, with or without a mild soap solution, carefully clean the fan base, pole and head. Please use caution around the motor housing area. Do not allow the motor or other electrical components to be exposed to water.

**FAN STORAGE**

Your fan can be stored either partially disassembled or assembled.

It is important to keep it in a safe, dry location.

- If stored disassembled, we recommend using the original (or appropriately sized) box.
- If stored assembled or partially assembled, remember to protect the fan head from dust.