

**CUSTOMER HELPLINE:**  
**01709 534123**



## STORAGE CHEST

## Step by Step Assembly Instructions

### Tools Required

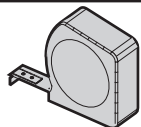

Tape Measure

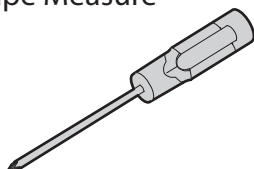

Cross Head Screwdriver



Hammer

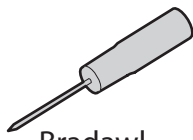

Bradawl

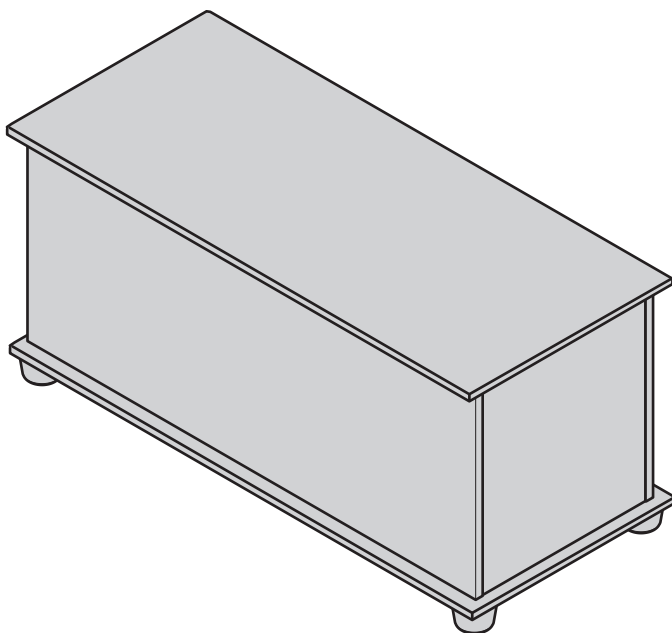

**ASSEMBLY TIME:**  
**1hr 30min Approx.**

**Product code**  
**005 XX 6507**

**Assembly Instruction**  
**610 00 6507**  
**Issue: D**

**Product Dimensions**  
**HHHxWWWxDDD**  
**470x990x435**

## Help and Advice **IMPORTANT! PLEASE READ**

**IMPORTANT!** Before you start take a few moments to read through this leaflet and then follow the step by step instructions. Do not throw away any of the packaging until you have checked that you have all the component parts and fittings.

Dear Customer,

In the unlikely event of you finding any parts either missing or faulty, it will not be necessary to go to the trouble of returning the complete item.

Simply contact us on CUSTOMER HELPLINE : 01709 534123 Between 8am - 4.30pm Monday to Thursday and 8am - 2.30p.m friday.

Please have the following information: Unit Description, Product Code, Product Colour, Place of Purchase, Catalogue Ref. No., Item Code, and have the assembly instructions close to hand.

We do have an answer machine should you contact us out of office hours, so in addition to the above information could you leave your name, address, daytime telephone number and the nature of your call on the answerphone. All calls will be actioned asap.

You can also e-mail your requests to us at: [customer.helpdesk@addspacefl.co.uk](mailto:customer.helpdesk@addspacefl.co.uk)

Alternatively Write to us at: Customer Service Department, Addspace Furniture Limited, Braithwell Way, Hellaby Industrial Estate, Hellaby, Rotherham, South Yorkshire, S66 8 QY.

DESCRIPTION	SIZE	QTY	CODE
TOP	990x409x15	1	6823
BOTTOM	990x435x15	1	4981
END	350x390x15	2	6824
FRONT	960x390x15	2	6826

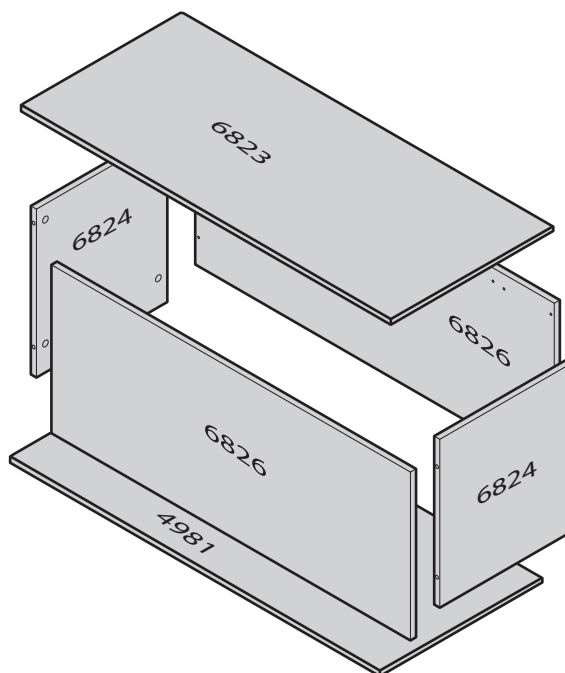

## FITTINGS

THE SCREWPACK CONTAINS ITEMS WHICH MAY PROVE DANGEROUS TO CHILDREN ESPECIALLY THOSE UNDER 36 MONTHS. WE THEREFORE RECOMMEND CAUTION IS OBSERVED DURING THE ASSEMBLY OF YOUR UNIT. IF THE UNIT CONTAINS SCREW COVERCAPS, WE SUGGEST THAT THESE ARE GLUED INTO POSITION.

<b>aa</b>  <b>CODE</b> 760001103 <b>QTY</b> 8	<b>bb</b>  <b>CODE</b> 760003004 <b>QTY</b> 8	<b>dd</b>  22mm <b>CODE</b> 690001018 <b>QTY</b> 5	<b>ee</b>  45mm <b>CODE</b> 690001075 <b>QTY</b> 6	<b>ff</b>  <b>CODE</b> 652001128 <b>QTY</b> 2
<b>gg</b>  <b>CODE</b> 653006000 <b>QTY</b> 2	<b>hh</b>  Thick 12mm <b>CODE</b> 690001008 <b>QTY</b> 4	<b>ii</b>  <b>CODE</b> 680003504 <b>QTY</b> 1		

THESE WILL DEPEND ON THE COLOUR OF YOUR UNIT

IF YOUR UNIT COLOUR IS PINE/IVORY	IF YOUR UNIT COLOUR IS WHITE	IF YOUR UNIT COLOUR IS BEECH
<b>VV</b> 	<b>VV</b> 	<b>VV</b> 
<b>CODE</b> 720006001 <b>QTY</b> 5	<b>CODE</b> 720365001 <b>QTY</b> 5	<b>CODE</b> 720001904 <b>QTY</b> 5

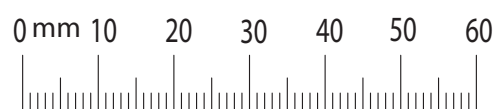

**IMPORTANT - NOTE: THICK LINES INDICATE FINISHED EDGES.**

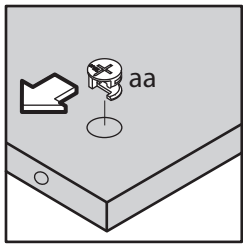

ENSURE CAM ARROW POINTS TOWARDS EDGE WITH HOLE.

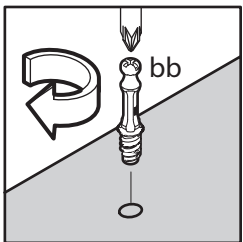

SCREW IN DOWEL UNTIL TIGHTENED.

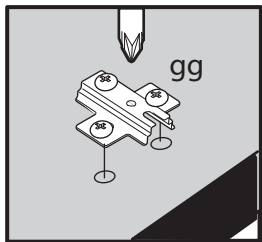

NOTE: NOTCH IN HINGE PLATE POINTS TOWARDS FINISHED EDGE.

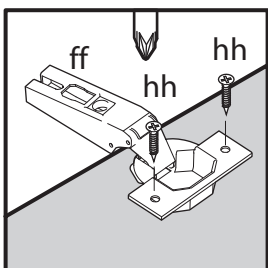

MARK WITH A BRADAWL BEFORE LOCATING SCREWS.

Fittings you will need in this step:

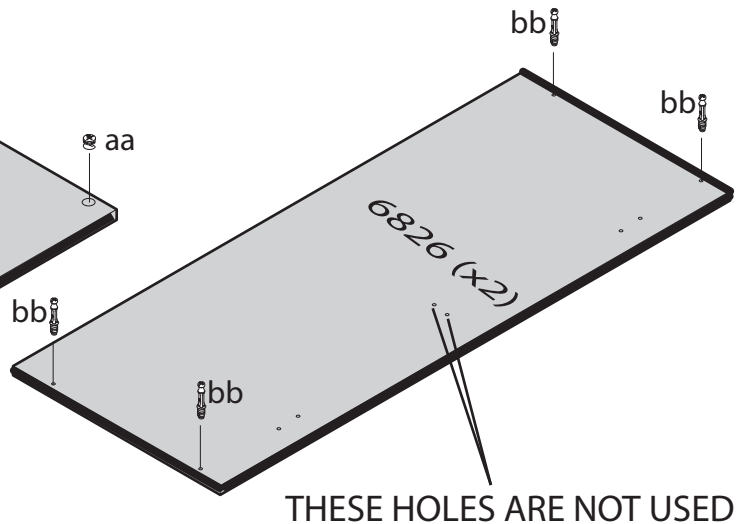
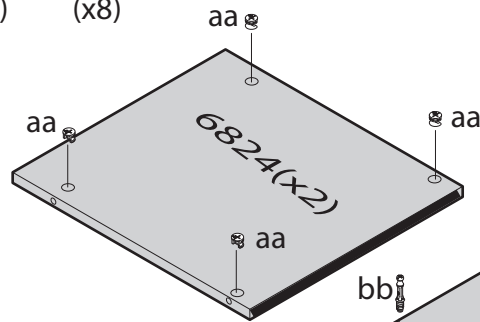
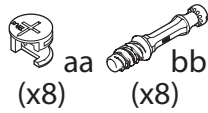

THESE HOLES ARE NOT USED

### LOCATE FITTINGS - CONT....

Fittings you will need in this step:

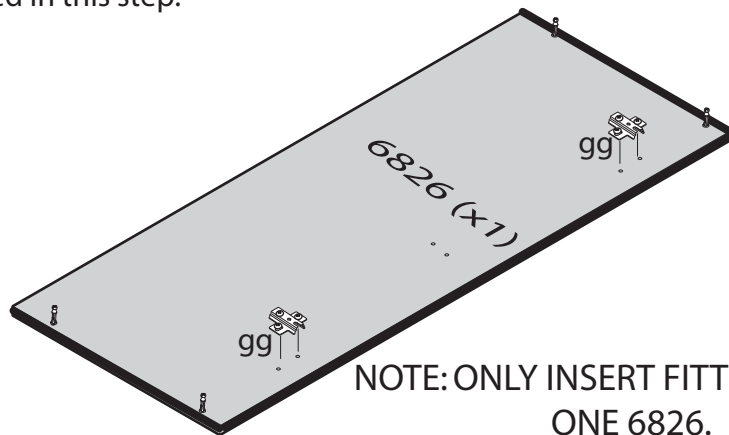
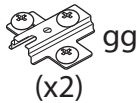

NOTE: ONLY INSERT FITTINGS gg IN ONE 6826.

### LOCATE FITTINGS - CONT....

Fittings you will need in this step:

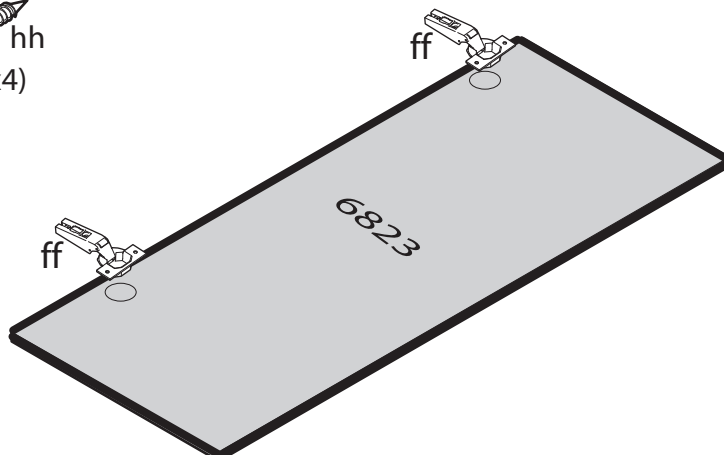
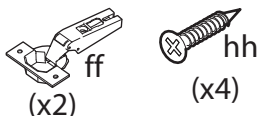

## ATTACH ENDS TO FRONT

LOCATE DOWELS IN  
PANEL 6826 INTO  
CAMS IN  
PANELS 6824.  
THEN LOCK.

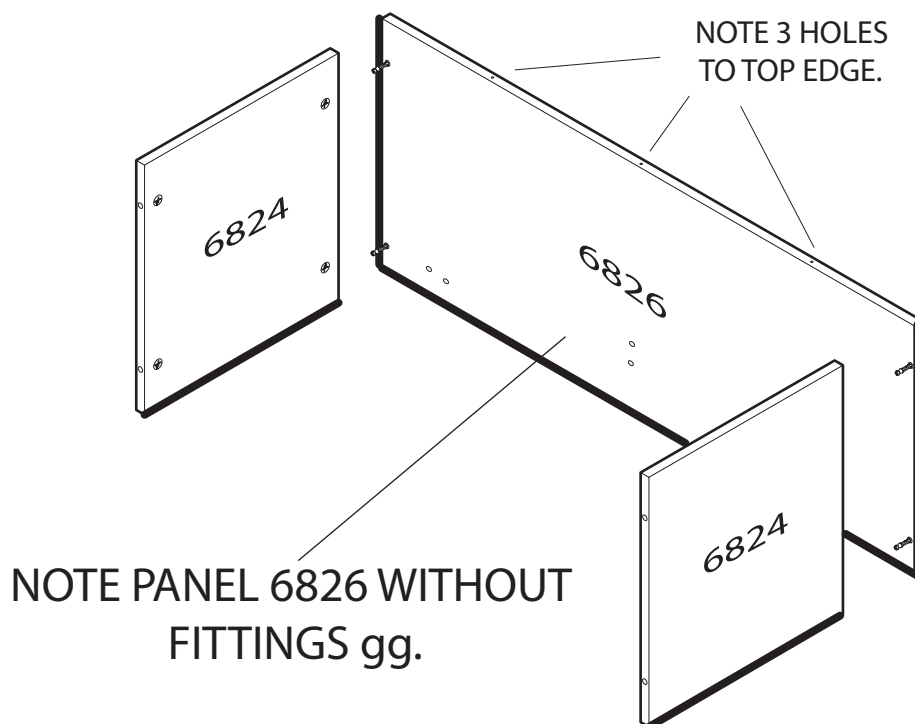

## STEP 3

## ATTACH FRONT

LOCATE DOWELS IN  
PANEL 6826 INTO  
CAMS IN  
PANELS 6824.  
THEN LOCK.

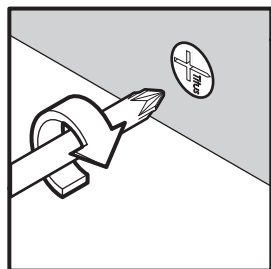

TURN CAM 180 DEGREES  
TO LOCK.

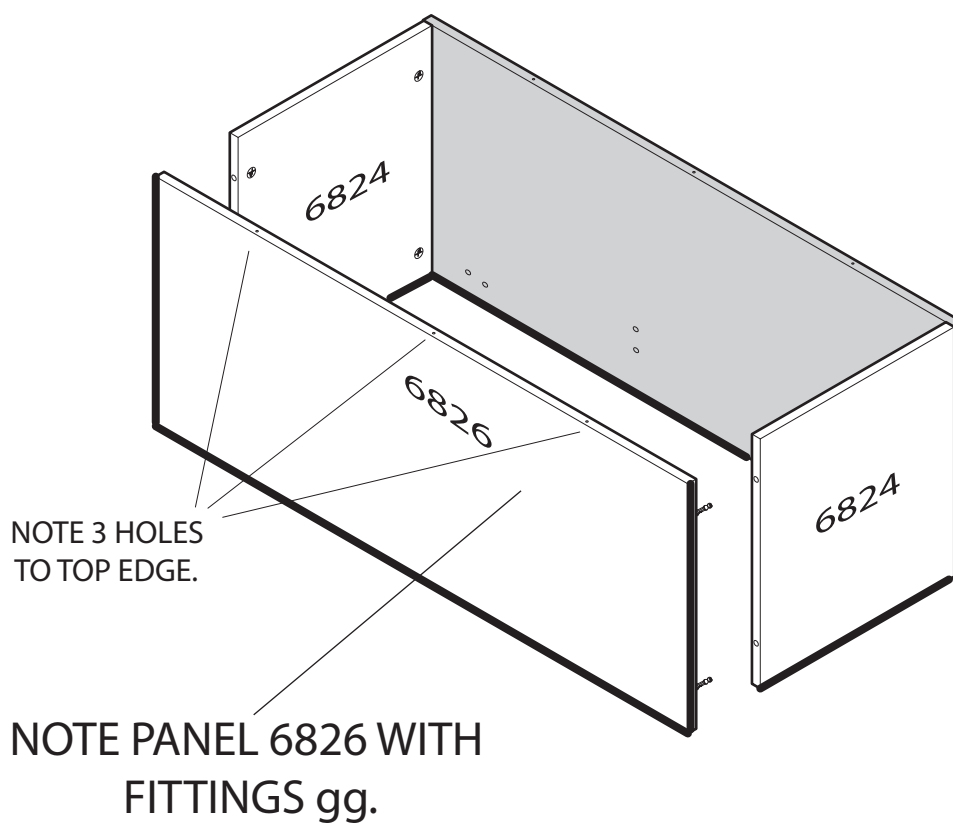

ATTACH BOTTOM

LOCATE SCREW  
FITTINGS (ee)  
THROUGH HOLES IN  
BOTTOM 4981 AND  
SCREW  
IN TO HOLES  
IN PANEL  
(6826)

Fittings you will need in this step:

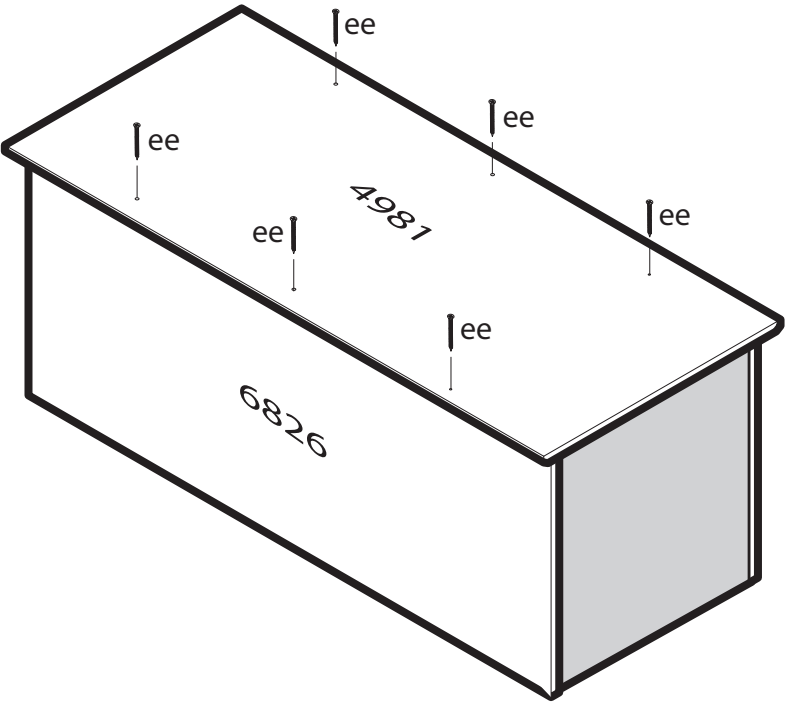
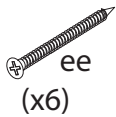

STEP 4

ATTACH FEET

LOCATE FEET TOWARDS  
THE CORNERS FOR MORE  
STABILITY. MARK POSITION  
WITH BRADAWL FIRST.

Fittings you will need in this step:

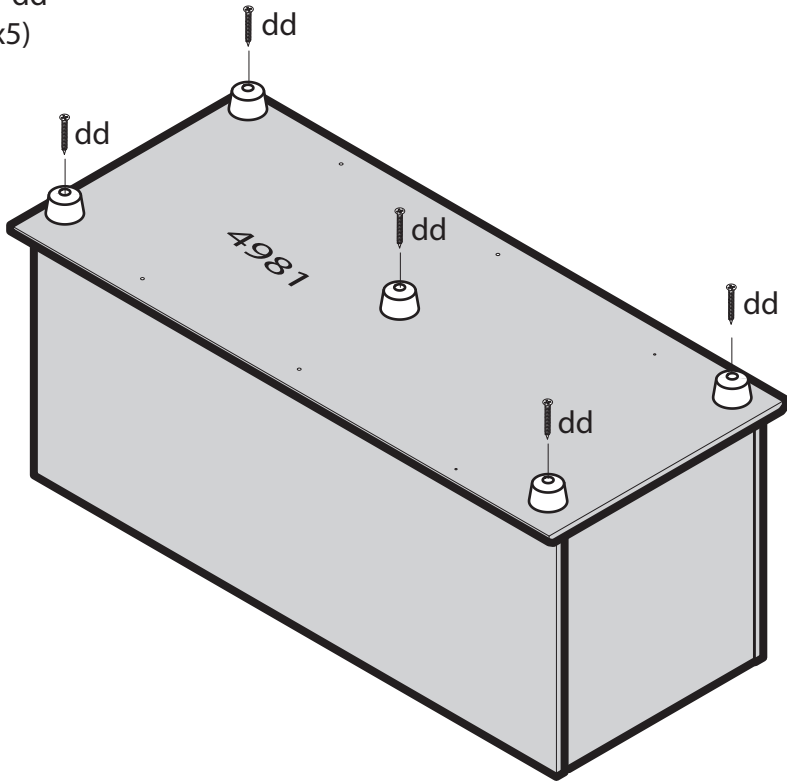
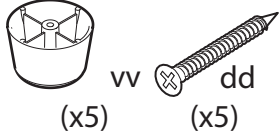

## LIFT UNIT UP THEN ATTACH TOP

SECURE DOORS  
BY PLACING  
ATTACHED HINGE ONTO  
SCREW (C) AND THEN  
TIGHTEN.

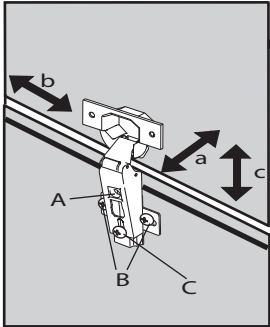

TO ADJUST THE DOOR IN  
DIRECTION (a) TURN  
SCREW (A).

TO ADJUST THE DOOR IN  
DIRECTION (b) RELEASE  
SCREWS (B) MOVE AS REQ-  
UIRED THEN RE-TIGHTEN.

TO ADJUST THE DOOR IN  
DIRECTION (c) RELEASE  
SCREW (C) BY ONE TURN  
MOVE AS REQUIRED THEN  
RE-TIGHTEN.

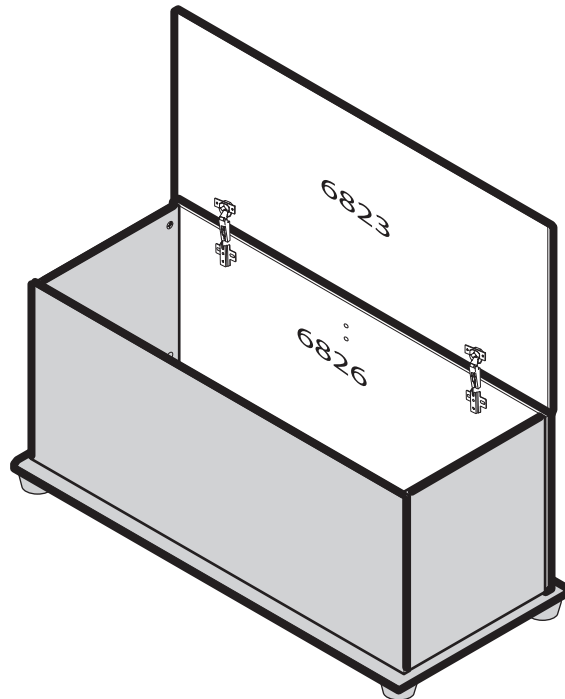

## STEP 6

## LOCATE PLASTIC BUFFERS

Fittings you will need in this step:

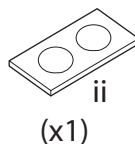

FINALLY LOCATE PLASTIC  
BUFFERS (ii)  
ON PANEL (6826).

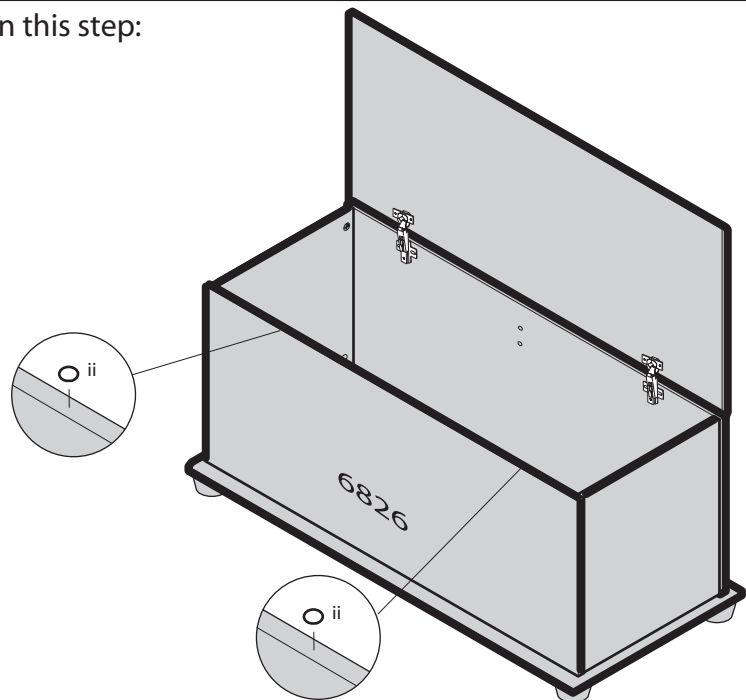

**CONGRATULATIONS YOUR UNIT IS NOW COMPLETE**

## AFTERCARE INSTRUCTIONS, PLEASE READ.

PLEASE NOTE: TO KEEP YOUR UNIT IN PERFECT CONDITION CLEAN ONLY WITH A SOFT DAMP CLOTH. DO NOT USE ANY ABRASIVE CHEMICAL CLEANERS. DO NOT SUBJECT YOUR UNIT TO HEAT OR MOISTURE. I.E BY PLACING HOT OR DAMP CUPS ETC ON ANY OF THE SURFACES. WE RECOMMEND THAT THE UNIT IS LIFTED AND NOT DRAGGED.